

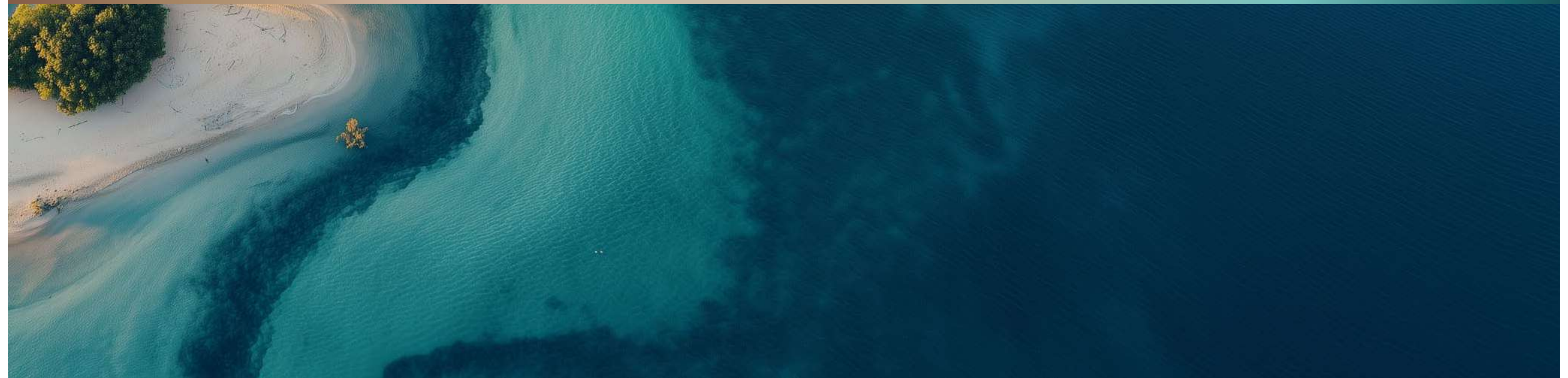

TRIO ISLE | INTERIORS BY
MISSONI



Where *three* worlds of luxury come together.

A woman in a dark dress stands on a sandy beach, looking out at the ocean. The water is a deep teal color with intricate, swirling patterns of white and gold, resembling marbled paper or a microscopic view of water. The woman's shadow is cast long and dark on the sand. The overall mood is contemplative and artistic.

Location. *Location.* Location.

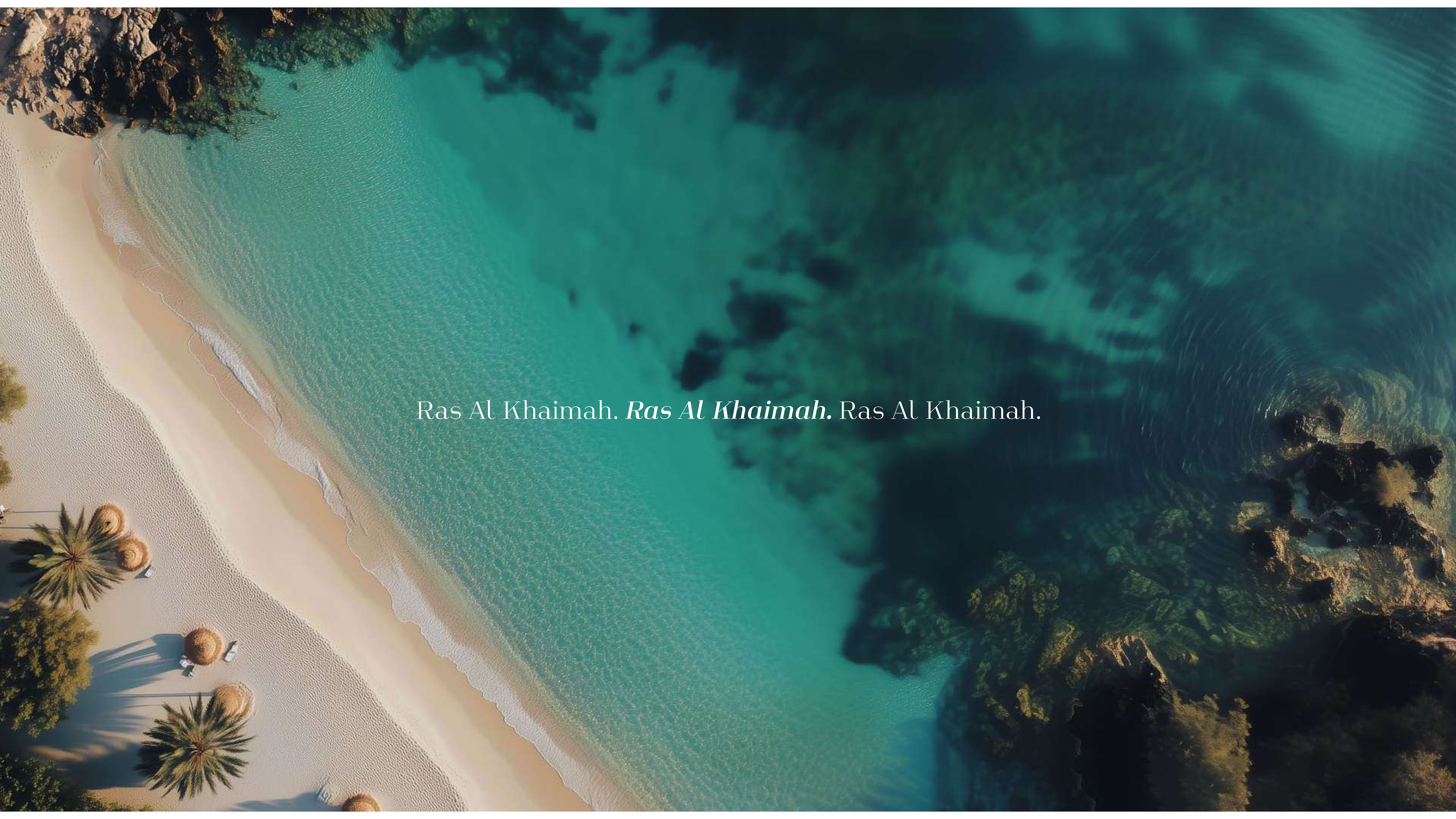

Ras Al Khaimah. *Ras Al Khaimah.* Ras Al Khaimah.



CULTURE

- Archeological findings dating back to 5,000 BC
- Area continuously inhabited for 7,000 years, 18 historic forts, castles, and towers.
- Offers unique perspective of UAE and RAK heritage

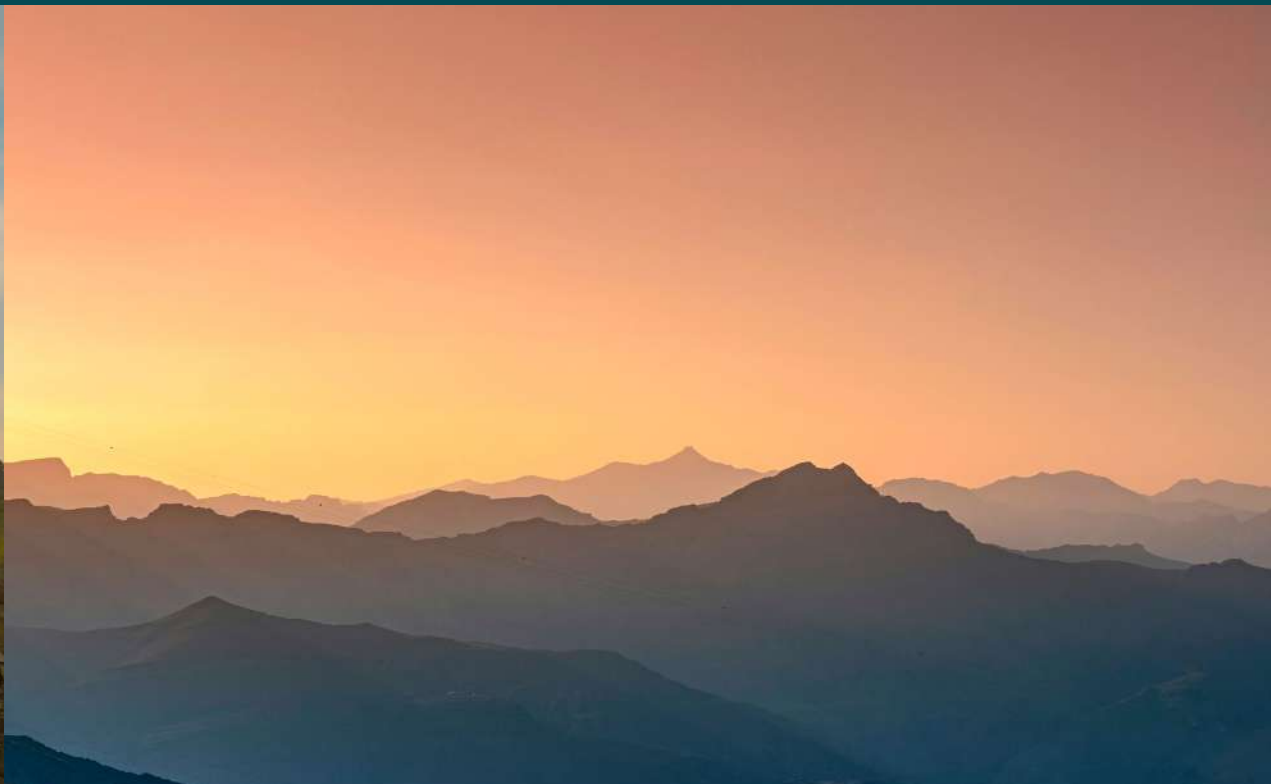

MOUNTAINS

- Jebel Jais, the UAE's tallest mountain at 1,900 meters
- Offers views of the coastline and valleys
- Up to 20-degree temperature differential to the coastline
- Offers hiking, rock-climbing, off-road trails and longest zipline in the world



DESERTS

- One of the UAE's most accessible pristine deserts
- Easily accessible from both the beach and the mountains
- Unique fauna and flora and dedicated nature reserves
- Offers off-roading, camping and safari experience



COASTLINE

- 43 kilometers of pristine coastline
- Golden-sand beaches and crystal-clear waters
- Natural mangroves
- Offers water sport activities

Nestled between the Hajar Mountains and the Arabian Gulf, it boasts a diverse landscape that includes stunning mountains, pristine beaches, and desert expanses.

Ras Al Khaimah is known for its rich cultural heritage and modern amenities, including luxury resorts, making it a popular destination for both tourists and expatriates seeking a unique blend of tradition and progress in the heart of the United Arab Emirates.

29.7%

YoY increase in total revenues earned by hospitality establishments in 2022 (316 million USD) amounting to 127 USD per available room.

3.53m

Number of guest nights spent in RAK in 2022. This represents a 27% YoY growth from 2021 figures.

56%

Market share held by domestic visitors in RAK in 2022, a slight drop from 2021 figures of 58%, pointing towards increased appeal to inbound visitors.

Location Map



TRIO ISLE | INTERIORS BY
MISSONI
AL MARJAN ISLAND

 **DXB AIRPORT**

E11

E11

E311

E87

 **RAK AIRPORT**

60 Minutes To Airport Via Sheikh Mohammed Bin Zayed Road



Al Marjan Island

Located at the tip of the UAE, Ras Al Khaimah enjoys a strategic location only 60 minutes from Dubai International Airport.

4

Islands

6

Fully Operational
World-Class Hotels

7.8

Km of Prestine
Beaches

2.7

Million Sqm of
Reclaimed Land

Island Map Projects

- 1. Trio Isle Interiors By Missoni
- 2. Moonstone Interiors By Missoni
- 3. La Mer By Elie Saab
- 4. Wynn Al Marjan

TRIO ISLE | INTERIORS BY
MISSONI





5 min away
Wynn Al Marjan

The background is a full-page image of marbled paper. It features a complex pattern of swirling, organic shapes in various shades of teal, turquoise, and seafoam green, interspersed with veins and patches of gold, tan, and brown. The overall effect is reminiscent of traditional stone or shell marbling techniques.

Brand. *Brand.* Brand.





Missoni is an iconic Italian luxury fashion house, renowned for its vibrant knitwear and bold geometric patterns. By the 1970s, it had redefined knitwear with a signature aesthetic blending art, fashion, and a distinctly Italian sensibility.

Beyond clothing, Missoni expanded into accessories, home furnishings, and fragrances, embracing a holistic vision of style. With a legacy of heritage and creativity, it represents an unmistakably Italian way of living and dressing that continues to captivate fashion lovers across generations.

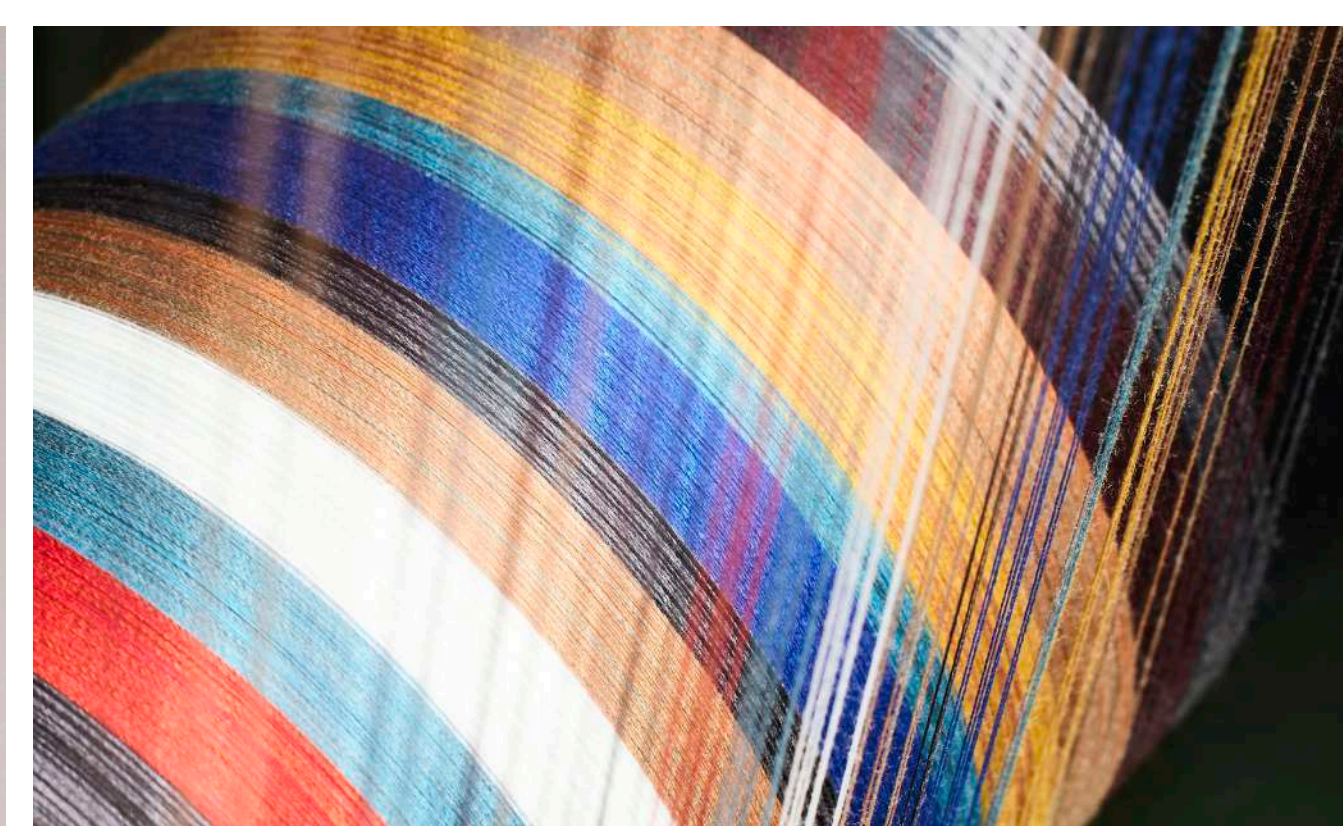

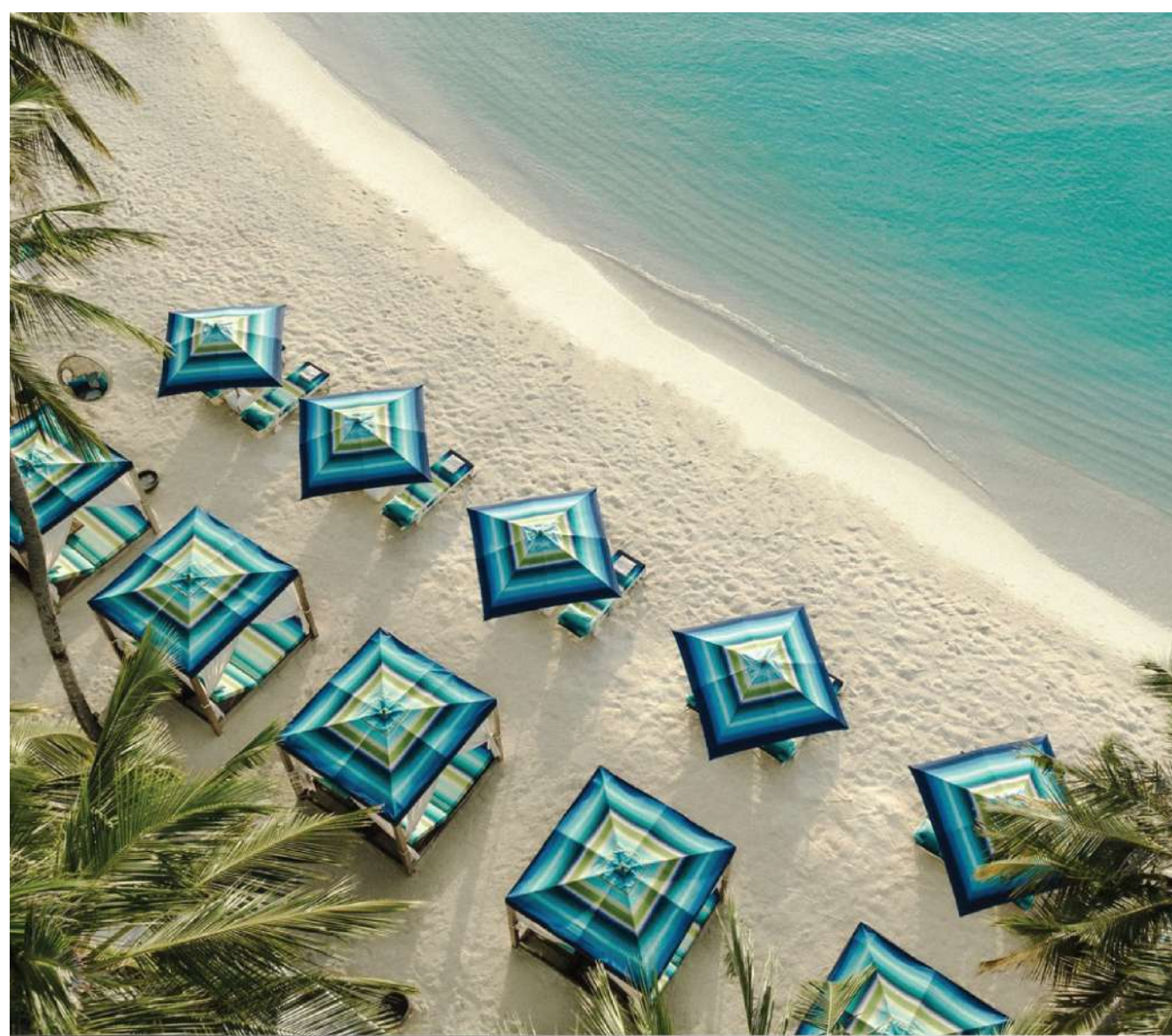
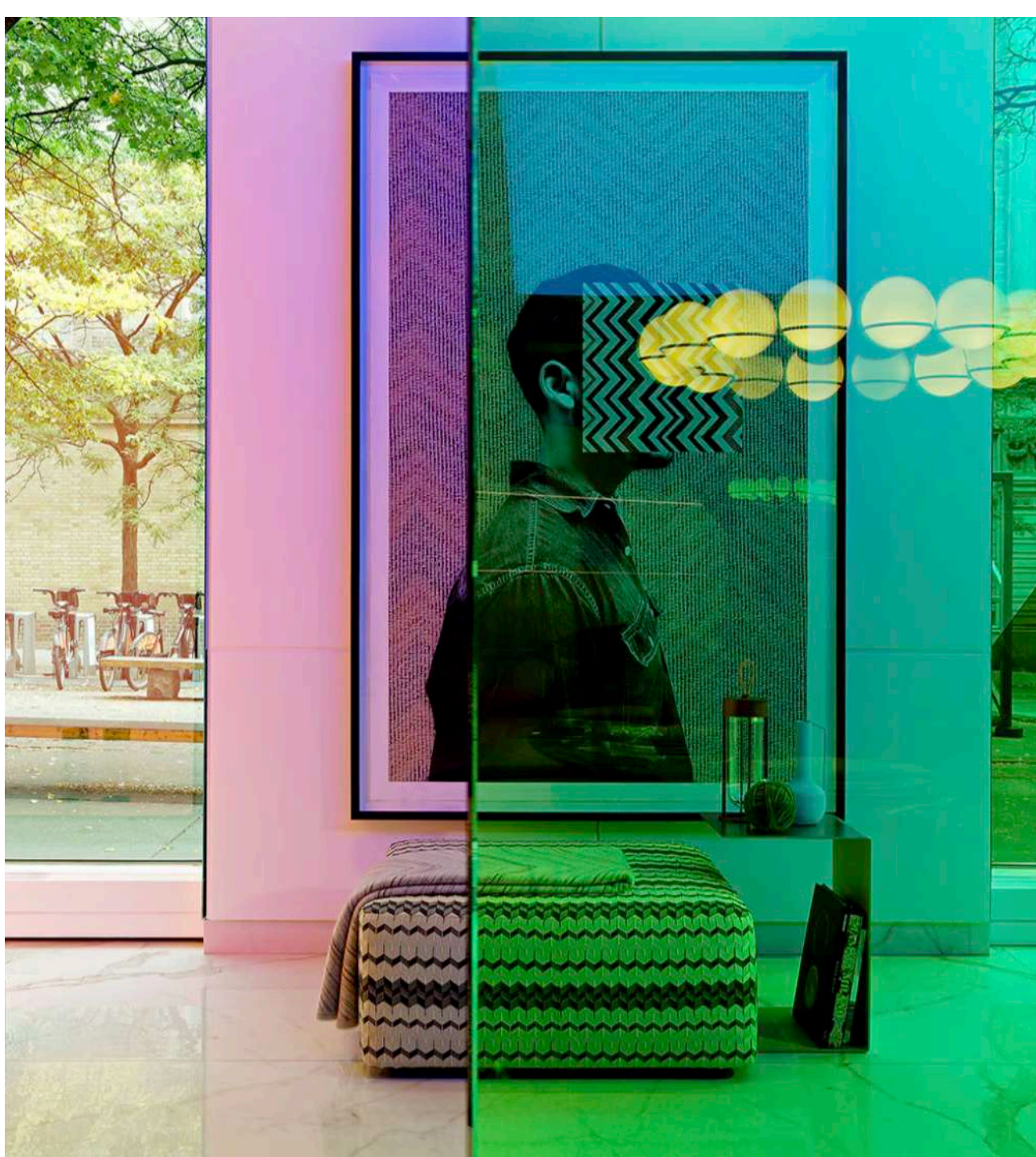

The Story

Trio Isle features three stunning buildings, each offering world-class design and impeccable finishes. With three levels of exceptional amenities, ***Trio Isle*** creates a harmonious blend of luxury and comfort.

Residents will enjoy a unique blend of experiences, from the serene beach to the refreshing pool and lush garden, all designed to elevate your lifestyle to new heights.

Trio Isle is where elegance meets innovation, making it the perfect destination for those seeking the ultimate in coastal living.



All images used are for illustrative purposes only and do not represent the actual size, features, specifications, fittings and furnishings. The developer reserves the right to make revisions / alterations, at its absolute discretion, without any liability whatsoever.

Plot Location Map

TRIO ISLE | INTERIORS BY **MISSONI**

800ft (240M)
Waterfront



All images used are for illustrative purposes only and do not represent the actual size, features, specifications, fittings and furnishings. The developer reserves the right to make revisions / alterations, at its absolute discretion, without any liability whatsoever.

A perfect *trio* of restaurants, amenities, and experiences await.

An aerial photograph of a tropical resort. The scene features a curved sandy beach on the left, a large swimming pool with a curved edge, and a dense area of lush green trees and palm trees. Several small, thatched-roof huts are nestled among the trees. The water is a deep blue-green color. The overall atmosphere is serene and luxurious.

Amenities. *Amenities.* Amenities.



25+ *Amenities*

Building Configuration - Amenities



Isle C

Isle B

Isle A

Rooftop

1st Level

2 Podiums

Ground Level

Masterplan



Ground Level (Indoor)

- 1. Main Lobby - Isle A,B & C
- 2. Pier Lobby - Isle B
- 3. Pier Restaurant- Isle B (2,592 Sqft)
- 4. Retail



Lobby



All images used are for illustrative purposes only and do not represent the actual size, features, specifications, fittings and furnishings.
The developer reserves the right to make revisions / alterations, at its absolute discretion, without any liability whatsoever.

Where every entrance is a *Missoni* moment.

Where the *Missoni* mood begins.

Reception

All images used are for illustrative purposes only and do not represent the actual size, features, specifications, fittings and furnishings.
The developer reserves the right to make revisions / alterations, at its absolute discretion, without any liability whatsoever.



Italian Restaurant



Beachfront Restaurant



Japanese Restaurant

Ground Level (Outdoor)

- 1. Water feature (7,212 Sqft)
- 2. Seating Pods (710 Sqft)
- 3. Sea View Restaurant Dining (2,852 Sqft)
- 4. Swimming Pool (2,583 Sqft)
- 5. Swimming Pool Bar & Dining (1,453 Sqft)
- 6. Viewing Points (215 Sqft)
- 7. Outdoor Seating (1,614 Sqft)
- 8. Fire Pit
- 9. Seating Area (7,212 Sqft)
- 10. Swim Up Bar
- 11. Feature Wall



Feature Wall & Retail



Amenities Walkthrough - Ground Level



Ground-Level Pool



All images used are for illustrative purposes only and do not represent the actual size, features, specifications, fittings and furnishings. The developer reserves the right to make revisions / alterations, at its absolute discretion, without any liability whatsoever.

Ground Sea-View Amenities



All images used are for illustrative purposes only and do not represent the actual size, features, specifications, fittings and furnishings. The developer reserves the right to make revisions / alterations, at its absolute discretion, without any liability whatsoever.

First Level (Indoor)

1. Entertainment Room (914 Sqft)
2. Office (58 Sqft)
3. Music & Art Room (1,269 Sqft)
4. Table Tennis Room (1,269 Sqft)
5. Teen's Club (914 Sqft)
6. Female Spa (1,346 Sqft)
7. Male Spa (1,346 Sqft)
8. Gym (3,541 Sqft)
9. Changing Room (Male/Female) (602 Sqft)

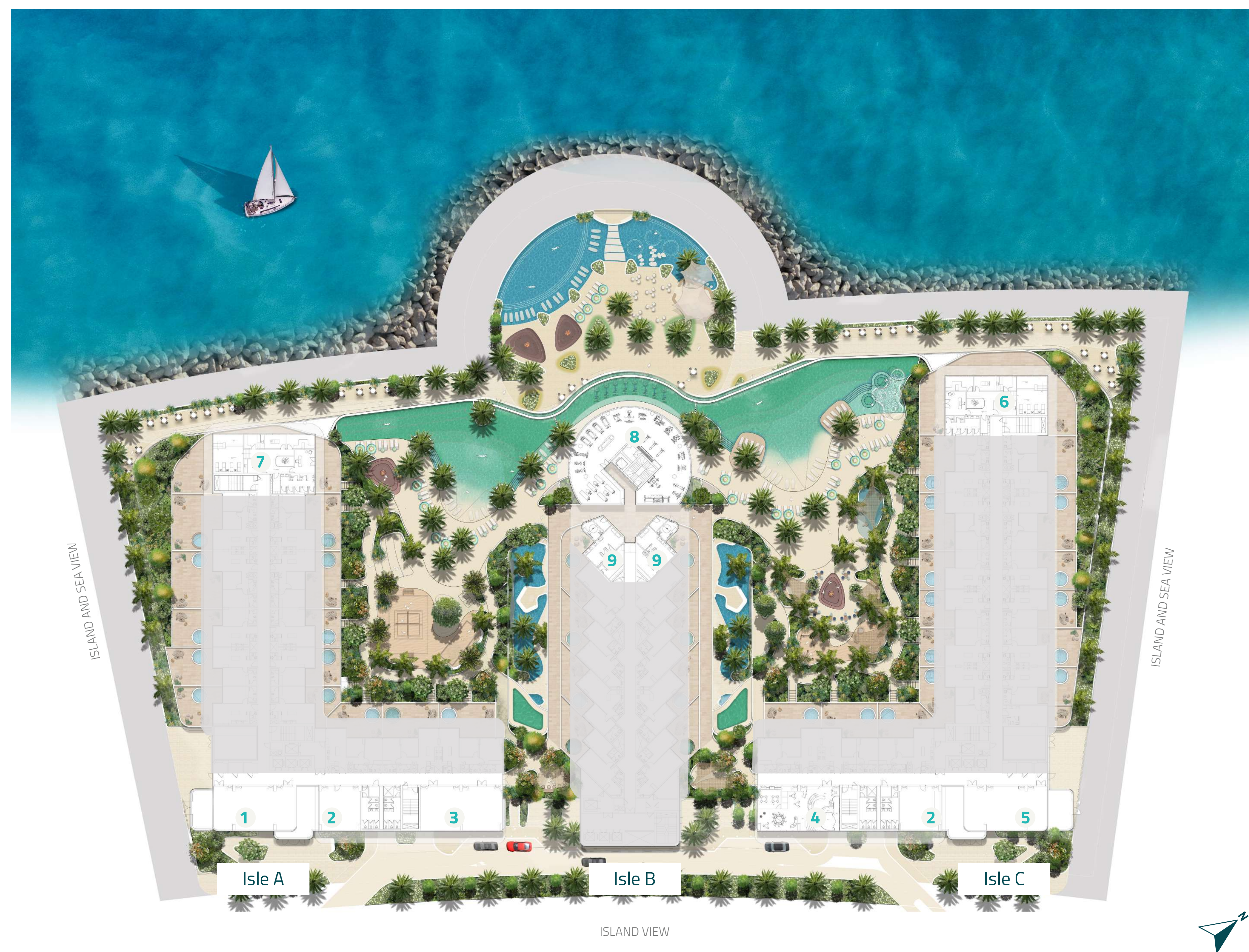









Treatment Room



First Level (Outdoor)

- 1. Adult Urban Beach Pool (4,843 Sqft)
- 2. Urban Beach Lap Pool
- 3. Pool Deck
- 4. Gym Pool (1,237 Sqft)
- 5. Kids Pool (484 Sqft)
- 6. Kids Play Area (645 Sqft)
- 7. BBQ & Social Area (2,260 Sqft)
- 8. Beach Volleyball (1,022 Sqft)
- 9. Beach Gym (430 Sqft)
- 10. Boules Court (269 Sqft)
- 11. Co-working Space (215 Sqft)
- 12. Sunbeds
- 13. Sunken Beds
- 14. Stargazing
- 15. Chill Area
- 16. Outdoor Shower
- 17. Salt Water Pool (5,112 Sqft)
- 18. Fire Pit



Amenities Walkthrough - First Level



Lap Pool

Gym Pool

Adult Urban Beach Pool

First Level Overview



All images used are for illustrative purposes only and do not represent the actual size, features, specifications, fittings and furnishings. The developer reserves the right to make revisions/alterations, at its absolute discretion, without any liability whatsoever.

Lap Pool



All images used are for illustrative purposes only and do not represent the actual size, features, specifications, fittings and furnishings. The developer reserves the right to make revisions / alterations, at its absolute discretion, without any liability whatsoever.

Gym Pool



All images used are for illustrative purposes only and do not represent the actual size, features, specifications, fittings and furnishings. The developer reserves the right to make revisions / alterations, at its absolute discretion, without any liability whatsoever.

Adult Urban Beach Pool



All images used are for illustrative purposes only and do not represent the actual size, features, specifications, fittings and furnishings. The developer reserves the right to make revisions / alterations, at its absolute discretion, without any liability whatsoever.

Amenities Walkthrough - First Level



Beach Volleyball



Amenities Walkthrough - First Level



BBQ & Social Area

Salt Water Pool

Kids Pool

Chill Area

Kids Play Area

Salt Water Pool



All images are for illustrative purposes only and do not represent the actual size, features, specifications, fittings and furnishings. The developer reserves the right to make revisions / alterations, at its absolute discretion, without any liability whatsoever.

Kids Play Area



All images used are for illustrative purposes only and do not represent the actual size, features, specifications, fittings and furnishings. The developer reserves the right to make revisions / alterations, at its absolute discretion, without any liability whatsoever.

Rooftop Level (Outdoor)

- 1. Swimming Pool (915 Sqft)
- 2. Pool Deck
- 3. Bar & Seating Area (861 Sqft)
- 4. Catwalk (861 Sqft)
- 5. Social Garden (323 Sqft)

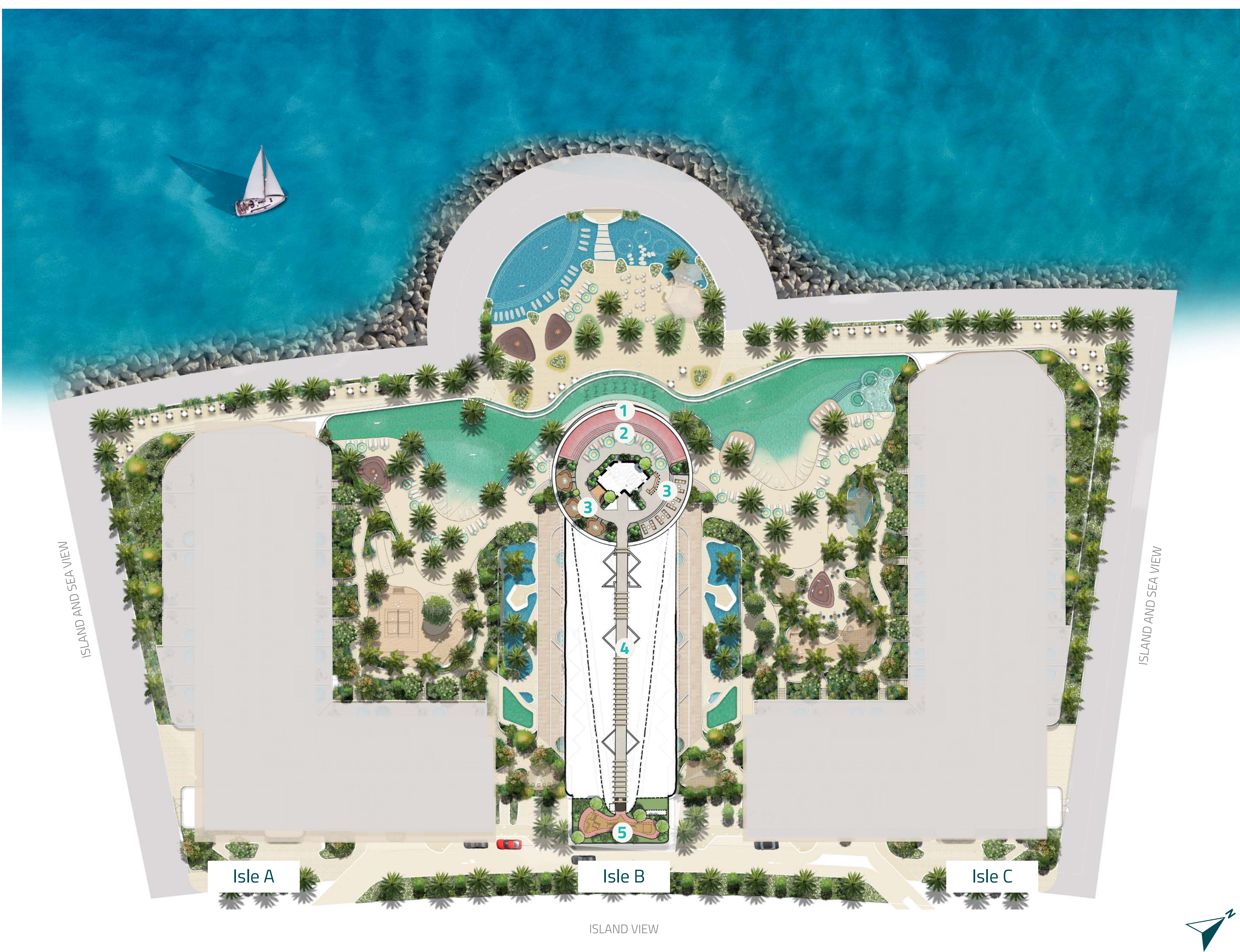

Catwalk

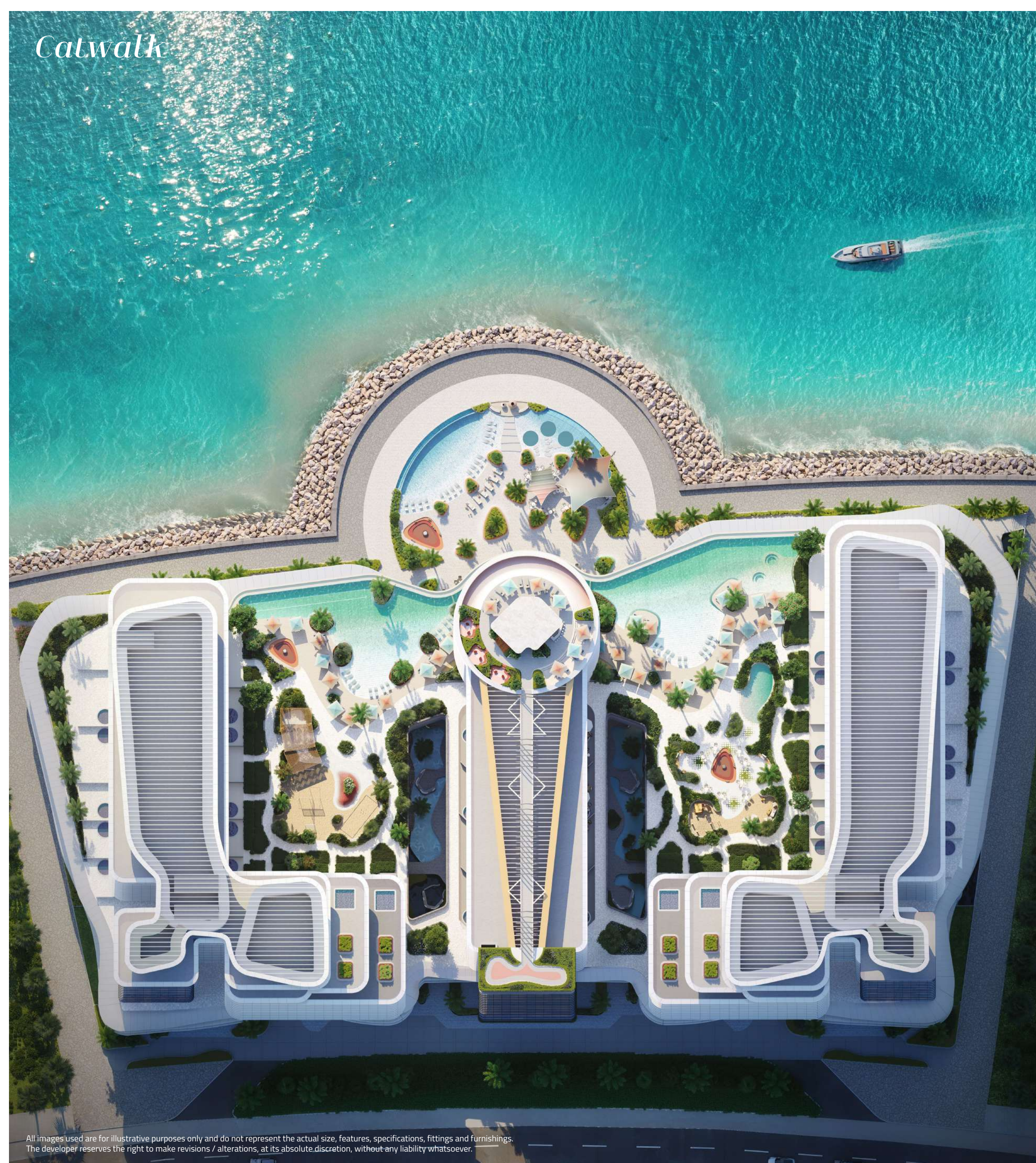

Where every entrance is a *Missoni* moment.

All images used are for illustrative purposes only and do not represent the actual size, features, specifications, fittings and furnishings.
The developer reserves the right to make revisions / alterations, at its absolute discretion, without any liability whatsoever.

Rooftop Seating Area



Rooftop Pool





Durar is one of the leading property development groups, offering a wide range of world-class solutions. Flexibility in planning and development ensures each client receives a strategic and highly personalized solution.

Among its celebrated projects is Elie Saab Edition Jasmine Lane at Jumeirah Golf Estate, which is a statement of luxury living and the J-One project in Business Bay.





OCTA Development came from a legacy of excellence, integrity, and innovation built by OCTA Properties. A foundation of delivering high-quality and functional living spaces has evolved into a commitment to creating purpose-driven, premium developments.

OCTA Development works under the motto Life². More than just a concept, it's the philosophy of redefining modern living by enhancing every detail, amplifying quality, and transforming the ordinary into the extraordinary.

Every space designed is crafted with intent, where functionality is heightened, efficiency is escalated, and excellence is magnified. Through practical planning and uncompromising quality.

OCTA Development creates spaces where life truly flourishes.



TRIO ISLE | INTERIORS BY
MISSONI

