

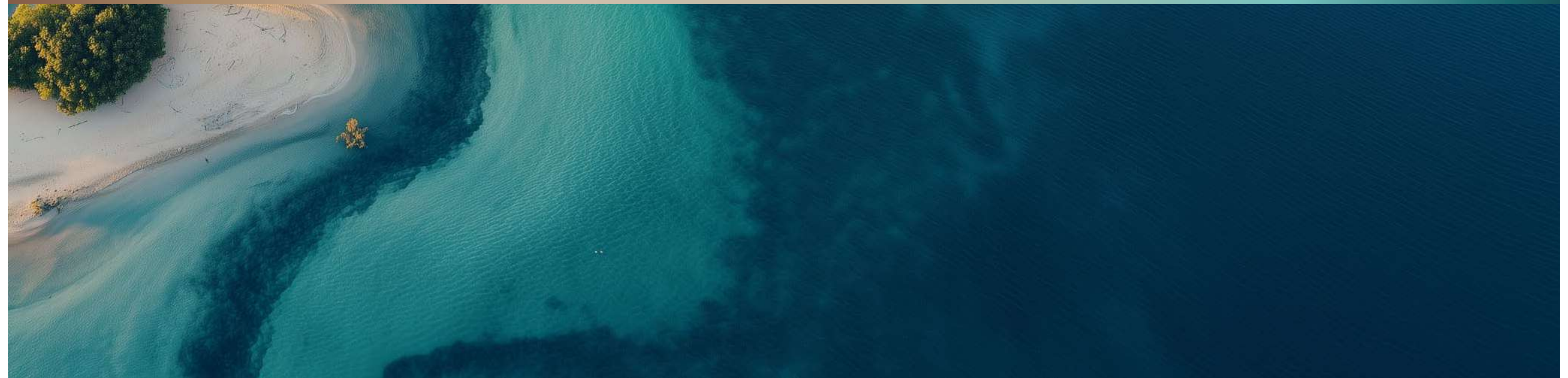

TRIO ISLE | INTERIORS BY  
**MISSONI**





Where *three* worlds of luxury come together.



A surreal landscape featuring a woman standing on a wavy, marbled path that separates a sandy beach on the left from a teal ocean on the right. The path is composed of intricate, swirling patterns of brown, tan, and white, resembling marbled paper or stone. The woman, seen from behind, is wearing a dark dress and has her shadow cast long and dark on the path. The ocean is a deep teal color with white-capped waves. The sky is a pale, hazy blue. The overall mood is dreamlike and contemplative.

Location. *Location.* Location.



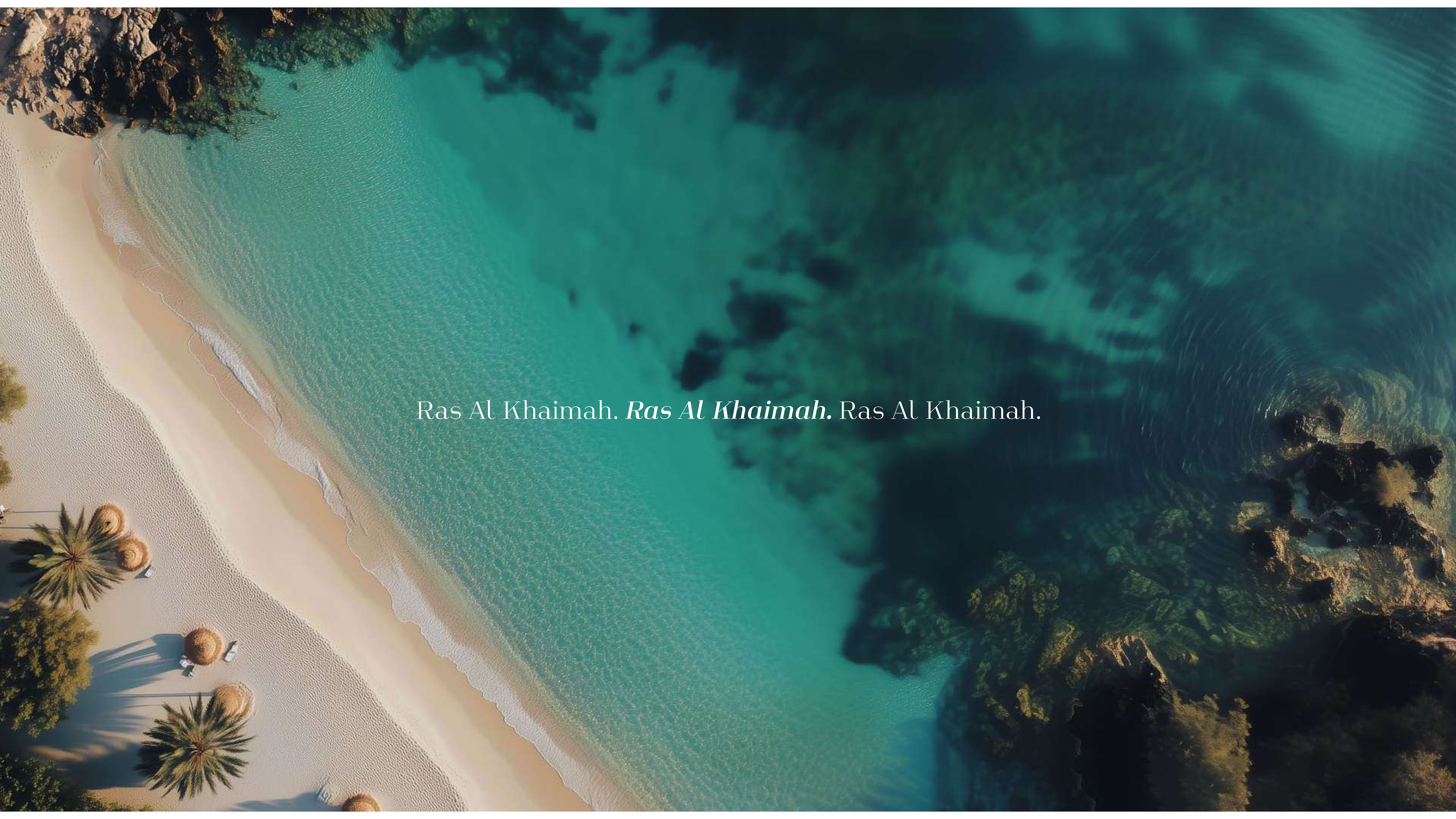

Ras Al Khaimah. *Ras Al Khaimah.* Ras Al Khaimah.





## CULTURE

- Archeological findings dating back to 5,000 BC
- Area continuously inhabited for 7,000 years, 18 historic forts, castles, and towers.
- Offers unique perspective of UAE and RAK heritage

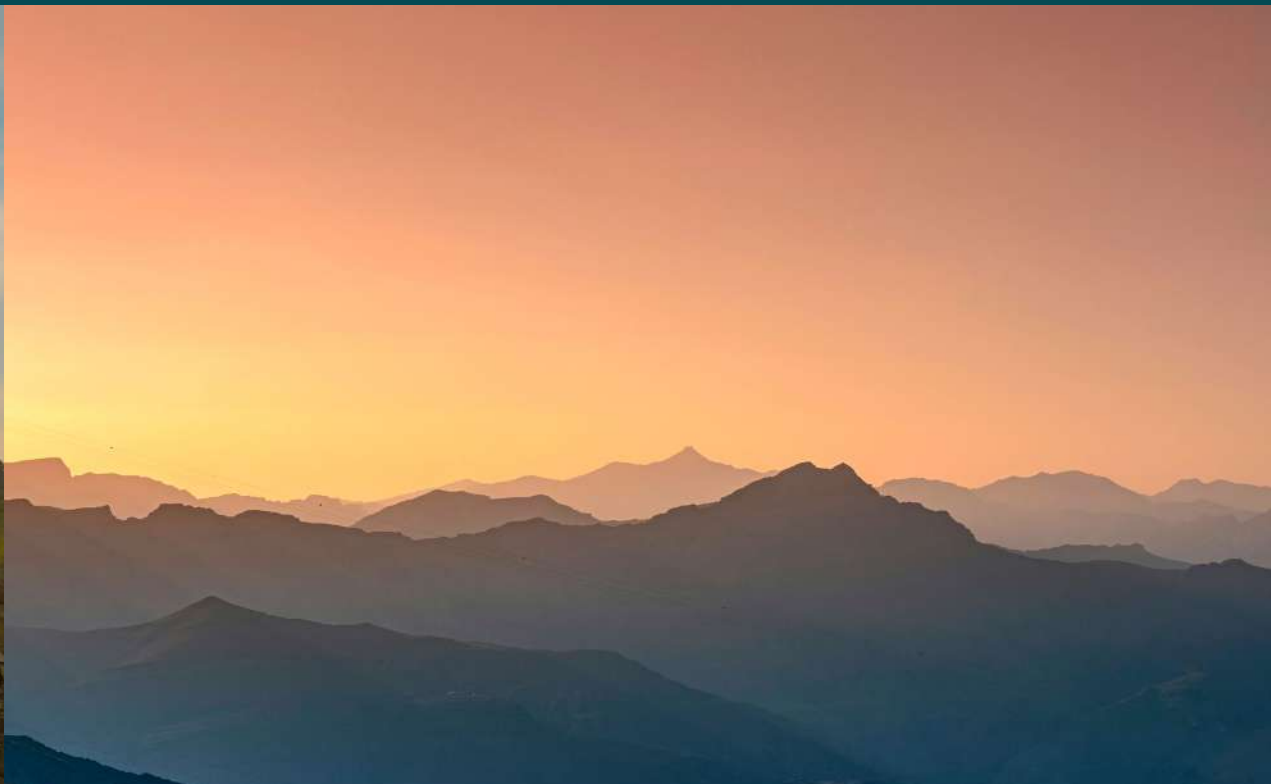

## MOUNTAINS

- Jebel Jais, the UAE's tallest mountain at 1,900 meters
- Offers views of the coastline and valleys
- Up to 20-degree temperature differential to the coastline
- Offers hiking, rock-climbing, off-road trails and longest zipline in the world



## DESERTS

- One of the UAE's most accessible pristine deserts
- Easily accessible from both the beach and the mountains
- Unique fauna and flora and dedicated nature reserves
- Offers off-roading, camping and safari experience



## COASTLINE

- 43 kilometers of pristine coastline
- Golden-sand beaches and crystal-clear waters
- Natural mangroves
- Offers water sport activities



Nestled between the Hajar Mountains and the Arabian Gulf, it boasts a diverse landscape that includes stunning mountains, pristine beaches, and desert expanses.

Ras Al Khaimah is known for its rich cultural heritage and modern amenities, including luxury resorts, making it a popular destination for both tourists and expatriates seeking a unique blend of tradition and progress in the heart of the United Arab Emirates.

29.7%

YoY increase in total revenues earned by hospitality establishments in 2022 (316 million USD) amounting to 127 USD per available room.

3.53m

Number of guest nights spent in RAK in 2022. This represents a 27% YoY growth from 2021 figures.

56%

Market share held by domestic visitors in RAK in 2022, a slight drop from 2021 figures of 58%, pointing towards increased appeal to inbound visitors.



Location Map



60 Minutes To Airport Via Sheikh Mohammed Bin Zayed Road



TRIO ISLE

INTERIORS BY  
**MISSONI**

Wynn Al Marjan

## Al Marjan Island

Located at the tip of the UAE, Ras Al Khaimah enjoys a strategic location only 60 minutes from Dubai International Airport.

4

Islands

6

Fully Operational  
World-Class Hotels

7.8

Km of Prestine  
Beaches

2.7

Million Sqm of  
Reclaimed Land



Island Map  
Projects

- 1. Trio Isle Interiors By Missoni
- 2. Moonstone Interiors By Missoni
- 3. La Mer By Elie Saab
- 4. Wynn Al Marjan

TRIO ISLE | INTERIORS BY  
**MISSONI**







5 min away  
*Wynn Al Marjan*

All images used are for illustrative purposes only and do not represent the actual size, features, specifications, fittings and furnishings.  
The developer reserves the right to make revisions / alterations, at its absolute discretion, without any liability whatsoever.



The background is a full-page image of marbled paper. It features a complex pattern of swirling, organic shapes in various shades of teal, turquoise, and seafoam green, interspersed with veins and patches of gold, tan, and brown. The overall effect is reminiscent of traditional stone or shell marbling techniques.

Brand. *Brand.* Brand.









Missoni is an iconic Italian luxury fashion house, renowned for its vibrant knitwear and bold geometric patterns. By the 1970s, it had redefined knitwear with a signature aesthetic blending art, fashion, and a distinctly Italian sensibility.

Beyond clothing, Missoni expanded into accessories, home furnishings, and fragrances, embracing a holistic vision of style. With a legacy of heritage and creativity, it represents an unmistakably Italian way of living and dressing that continues to captivate fashion lovers across generations.

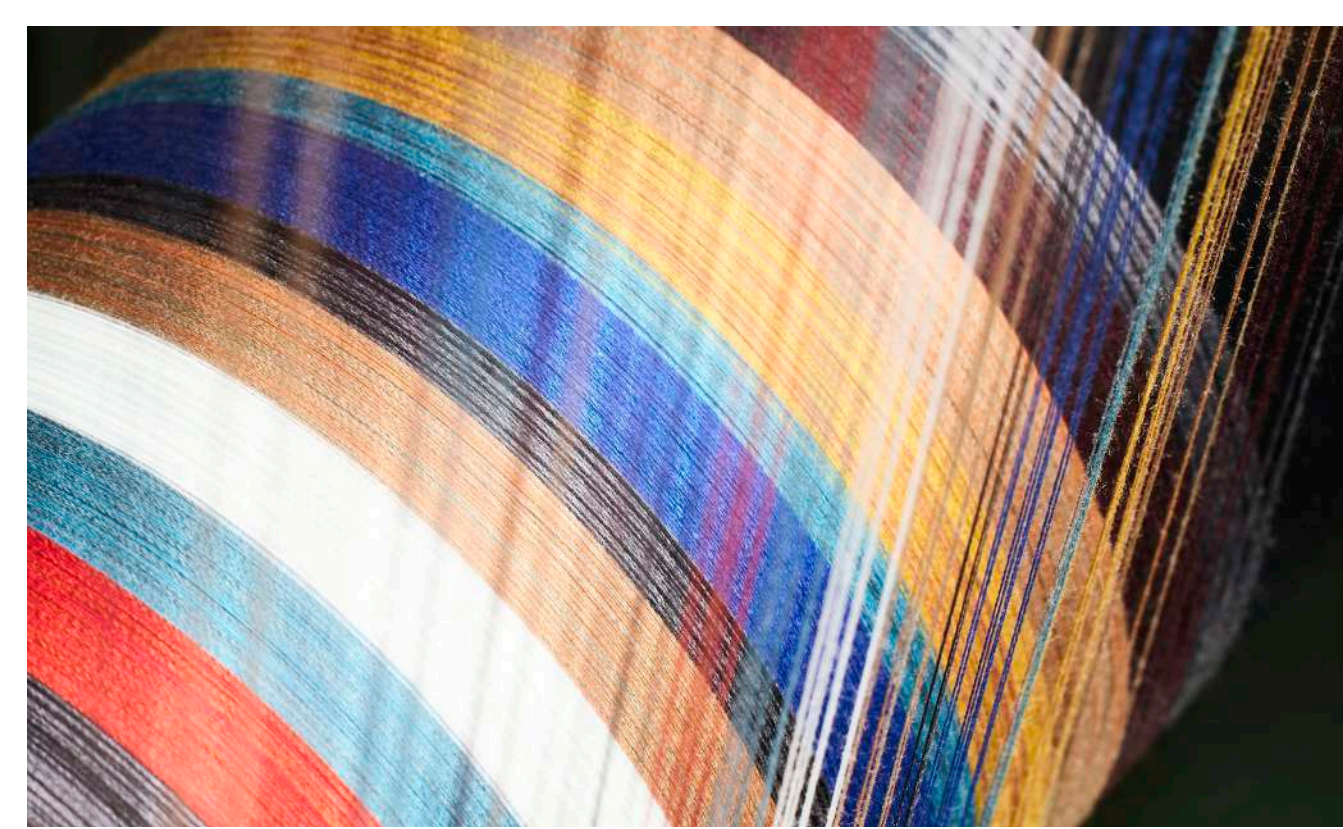



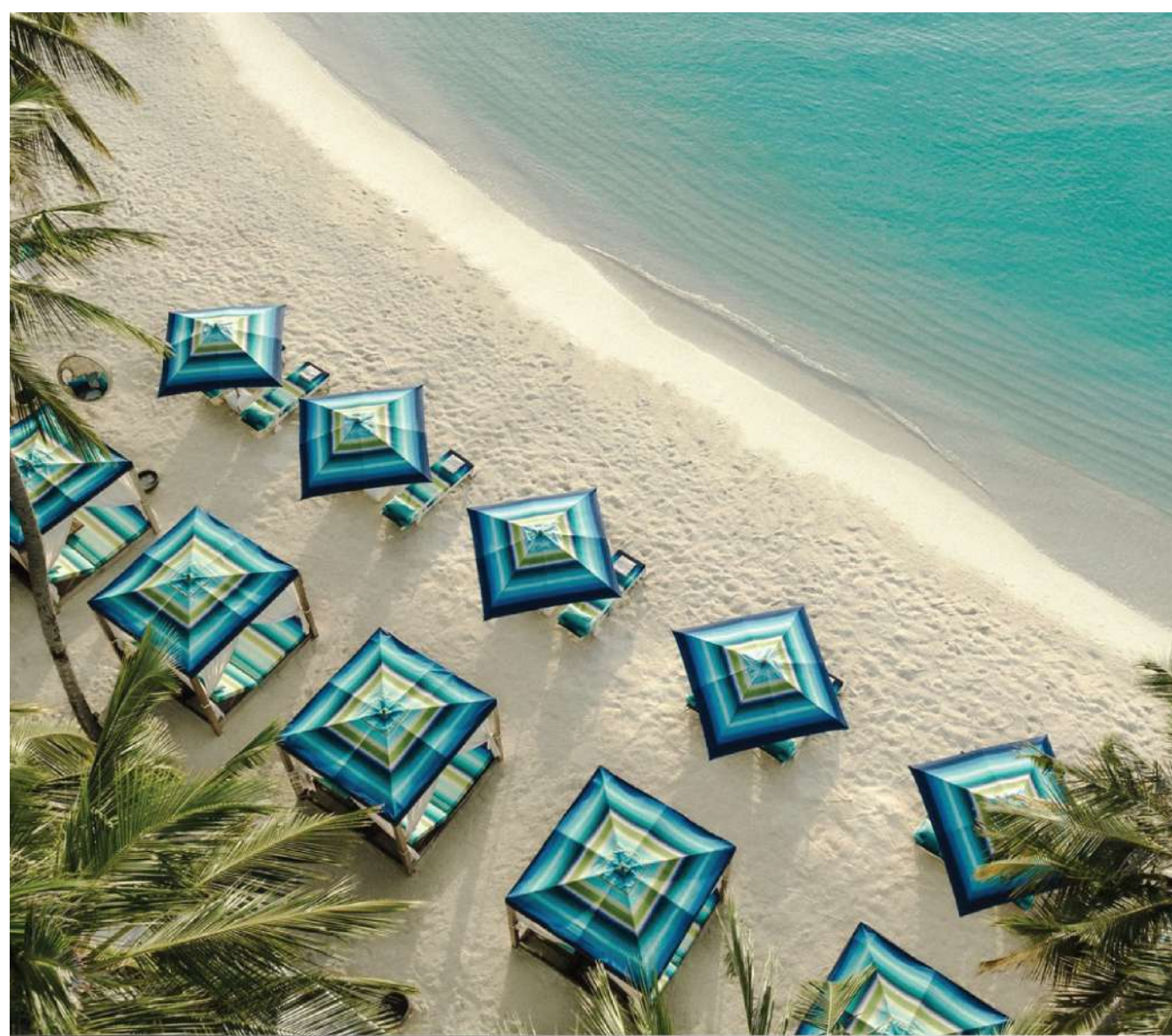
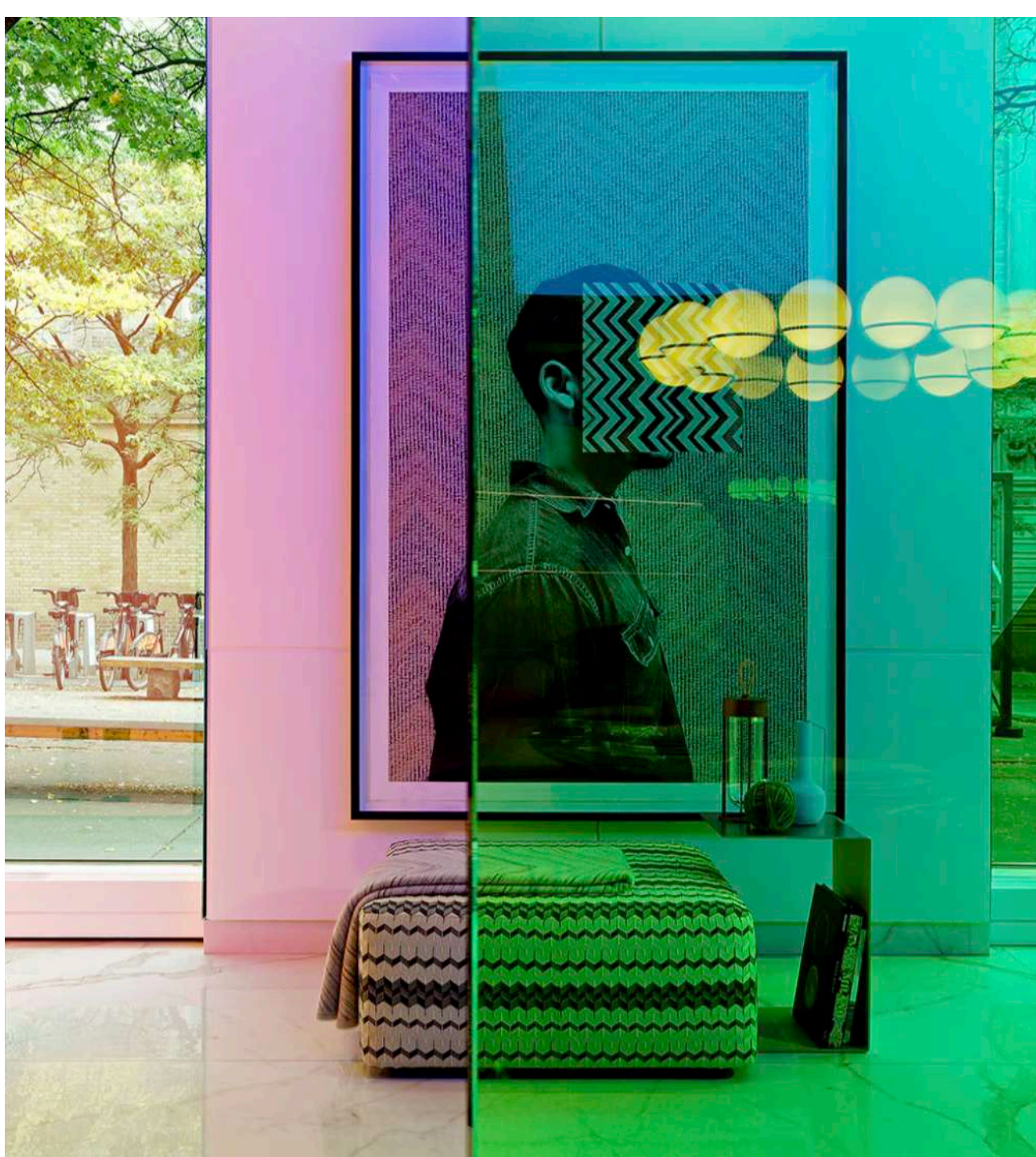



# MISSONI

## REAL ESTATE PROJECTS



MIAMI



DUBAI



MARBELLA



SAO PAULO



BODRUM



TORONTO



AL MARJAN ISLAND, RAK



AL MARJAN ISLAND, RAK



## The Story

***Trio Isle*** features three stunning buildings, each offering world-class design and impeccable finishes. With three levels of exceptional amenities, ***Trio Isle*** creates a harmonious blend of luxury and comfort.

Residents will enjoy a unique blend of experiences, from the serene beach to the refreshing pool and lush garden, all designed to elevate your lifestyle to new heights.

***Trio Isle*** is where elegance meets innovation, making it the perfect destination for those seeking the ultimate in coastal living.



All images used are for illustrative purposes only and do not represent the actual size, features, specifications, fittings and furnishings. The developer reserves the right to make revisions / alterations, at its absolute discretion, without any liability whatsoever.



Plot Location Map

TRIO ISLE | INTERIORS BY  
**MISSONI**

800ft (240M)  
Waterfront



All images used are for illustrative purposes only and do not represent the actual size, features, specifications, fittings and furnishings.  
The developer reserves the right to make revisions / alterations, at its absolute discretion, without any liability whatsoever.



Project  
Details

Project Name		Trio Isle			
Developer		DURAR OCTA FZ LLC			
Branded		MISSONI			
Architect		QHC Architects and Engineers			
Location		Al Marjan Island, Ras Al Khaimah			
Anticipated Completion Date		Q1 2028			
Anticipated Service Charges		AED 18 per Sqft			
Furnished		No			
Brand of White Goods		Bosch or Equivalent			
Height		B + G +2P +12			
Ceiling Height		Living Room 2.8 - 3 M   Kitchen & Bathroom 2.6 M			
Elevators		Isle A & C    (3 Residential, 1 Service)			
		Isle B            (4 Residential, 1 Service)			
Parking Per Unit		1 Parking: STD, 1BR, 2BR 2 Parkings: 3BR			
Unit Mix	1BR	2BR	3BR	RETAIL	TOTAL
Isle A	72	79	13	2	166
Isle B	85	33	11	4	133
Isle C	84	91	13	2	190
Total	241	203	37	8	489





Floor Plans. *Floor Plans.* Floor Plans.



# Building Configuration



All images used are for illustrative purposes only and do not represent the actual size, features, specifications, fittings and furnishings. The developer reserves the right to make revisions / alterations, at its absolute discretion, without any liability whatsoever.



# Masterplan





Typical Floor  
1<sup>st</sup> Level

All images used are for illustrative purposes only and do not represent the actual size, features, specifications, fittings and furnishings. The developer reserves the right to make revisions / alterations, at its absolute discretion, without any liability whatsoever.

- 2 BEDROOM
- 1 BEDROOM
- UNBRANDED STUDIOS





Typical Floor  
2<sup>nd</sup> Level

All images used are for illustrative purposes only and do not represent the actual size, features, specifications, fittings and furnishings. The developer reserves the right to make revisions / alterations, at its absolute discretion, without any liability whatsoever.

- 3 BEDROOM
- 2 BEDROOM
- 1 BEDROOM

UNBRANDED STUDIOS





Typical Floor  
3<sup>rd</sup> Level

All images used are for illustrative purposes only and do not represent the actual size, features, specifications, fittings and furnishings. The developer reserves the right to make revisions / alterations, at its absolute discretion, without any liability whatsoever.

- 3 BEDROOM
- 2 BEDROOM
- 1 BEDROOM

UNBRANDED STUDIOS





Typical Floor  
4<sup>th</sup>-10<sup>th</sup> Level

All images used are for illustrative purposes only and do not represent the actual size, features, specifications, fittings and furnishings. The developer reserves the right to make revisions / alterations, at its absolute discretion, without any liability whatsoever.

- 3 BEDROOM
- 2 BEDROOM
- 1 BEDROOM
- UNBRANDED STUDIOS





Typical Floor  
11<sup>th</sup> Level

All images used are for illustrative purposes only and do not represent the actual size, features, specifications, fittings and furnishings. The developer reserves the right to make revisions / alterations, at its absolute discretion, without any liability whatsoever.

- 3 BEDROOM
- 2 BEDROOM
- 1 BEDROOM

UNBRANDED STUDIOS





Typical Floor  
12<sup>th</sup> Level

All images used are for illustrative purposes only and do not represent the actual size, features, specifications, fittings and furnishings. The developer reserves the right to make revisions / alterations, at its absolute discretion, without any liability whatsoever.

- 3 BEDROOM
- 2 BEDROOM
- 1 BEDROOM

UNBRANDED STUDIOS







Unit Layouts. *Unit Layouts.* Unit Layouts.



# 1 Bedroom | Moodboard

## Living Area

### FINISHING MATERIALS

- 1. AUSTRALIA FABRIC SOFA
- 2. MAREA CARPET
- 3. ICELAND CUSHION
- 4. COMETEA CUSHION
- 5. BLUE RAPPORTO CHAIR
- 6. MISSONI CURTIANS
- 7. LIGHT OAK WOOD FLOORING
- 8. BLUE GLASS RIBBED UPPER CABINETS KITCHEN
- 9. LOWER CABINETS KITCHEN
- 10. CALACATTA PORCELAIN TILE COUNTERTOP
- 11. BRONZE BRUSHED FAUCET

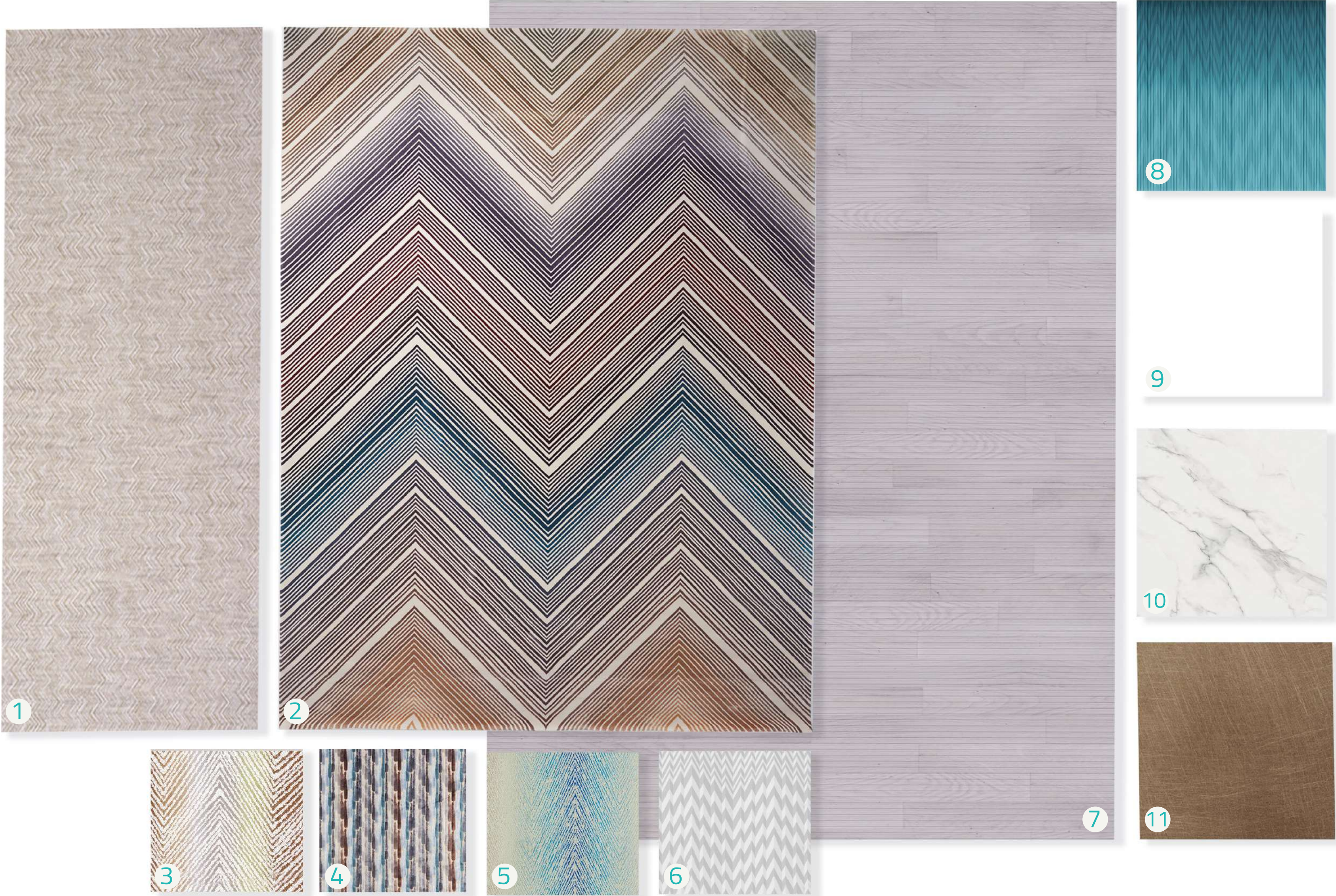



# 1 Bedroom | Moodboard

## Powder Room

### FINISHING MATERIALS

- 1. STONE FLOORING
- 2. FLUTED STONE WALL
- 3. GREY MIRROR
- 4. BLUE ONYX PORCELAIN TILE VANITY
- 5. LIGHT OAK WOOD SHELF
- 6. BLUE GIACOMO TOWEL
- 7. GOLD BRUSHED BATHROOM ACCESORIES

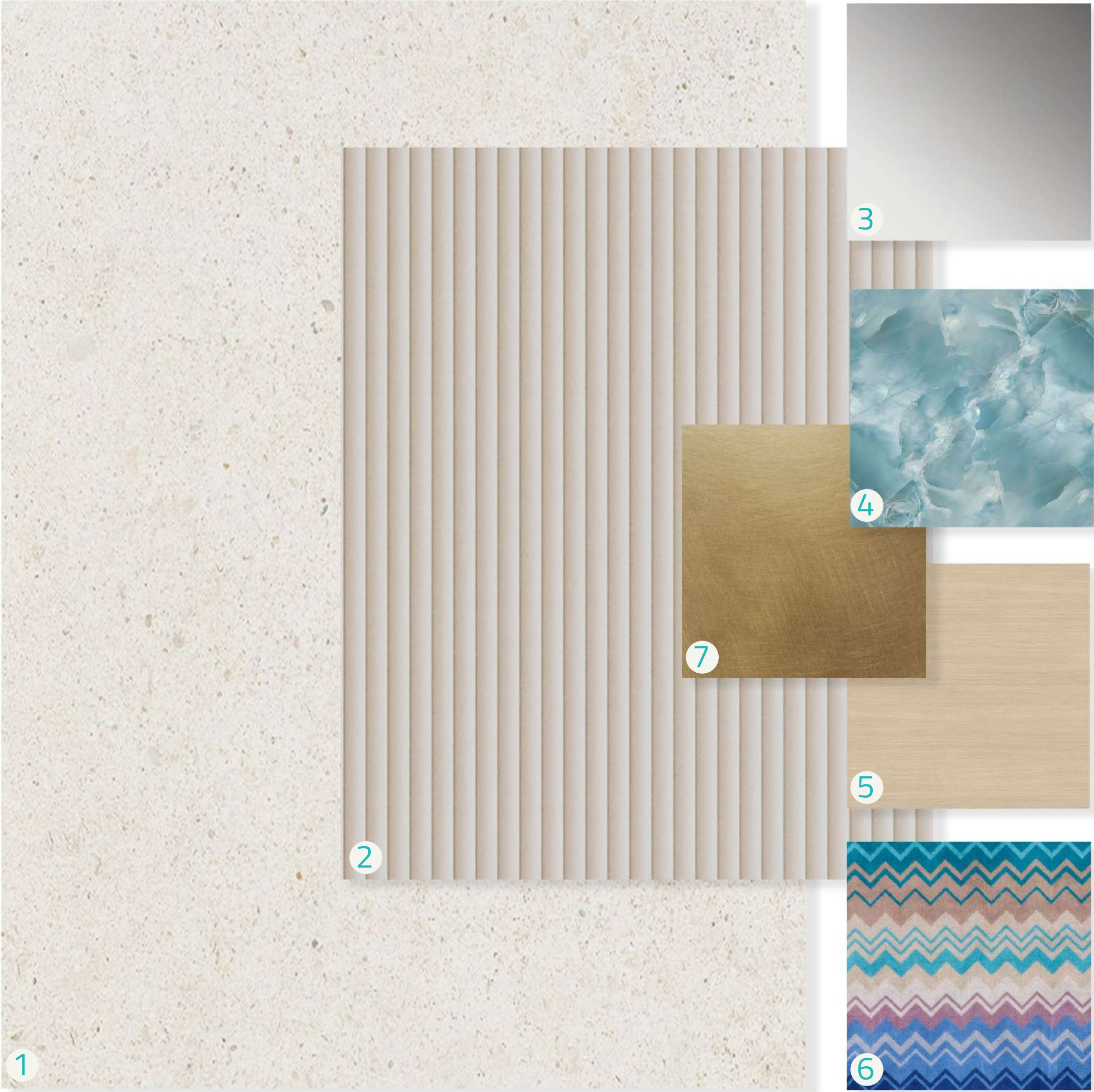



# 1 Bedroom | Moodboard Bedroom

## FINISHING MATERIALS

- 1. AUSTRALIA FABRIC BED
- 2. METAL CHEVRON CARPET
- 3. WIND WHITE DUVET
- 4. GRAFFITI BLANKET
- 5. AGADIR CUSHION
- 6. ICELAND CUSHION
- 7. ANDE CUSHION
- 8. NASTRI POUF
- 9. BLUE RIBBED GLASS
- 10. LIGHT OAK WOOD FLOORING
- 11. GREY MIRROR
- 12. GLASS MOSAIC WALL
- 13. CALACATTA MARBLE SIDE TABLE





# 1 Bedroom | Type 1

- 1. MASTER BEDROOM (4600 x 3100)
- 2. MASTER BATHROOM (1500 x 2600)
- 3. KITCHEN/ DINING (2900 x 3600)
- 4. LIVING ROOM (3400 x 3600)
- 5. POWDER ROOM (1500 x 1300)
- 6. BALCONY



DESCRIPTION	SIZE RANGE
INTERNAL AREA	525 - 548 Sqft
BALCONY AREA	125 - 139 Sqft
TOTAL AREA	625 - 678 Sqft





# 1 Bedroom | Type 1 With Pool

- 1. MASTER BEDROOM (4600 x 3100)
- 2. MASTER BATHROOM (1500 x 2600)
- 3. KITCHEN/ DINING (2900 x 3600)
- 4. LIVING ROOM (3400 x 3600)
- 5. POWDER ROOM (1500 x 1300)
- 6. BALCONY
- 7. POOL (2400 x 2400)

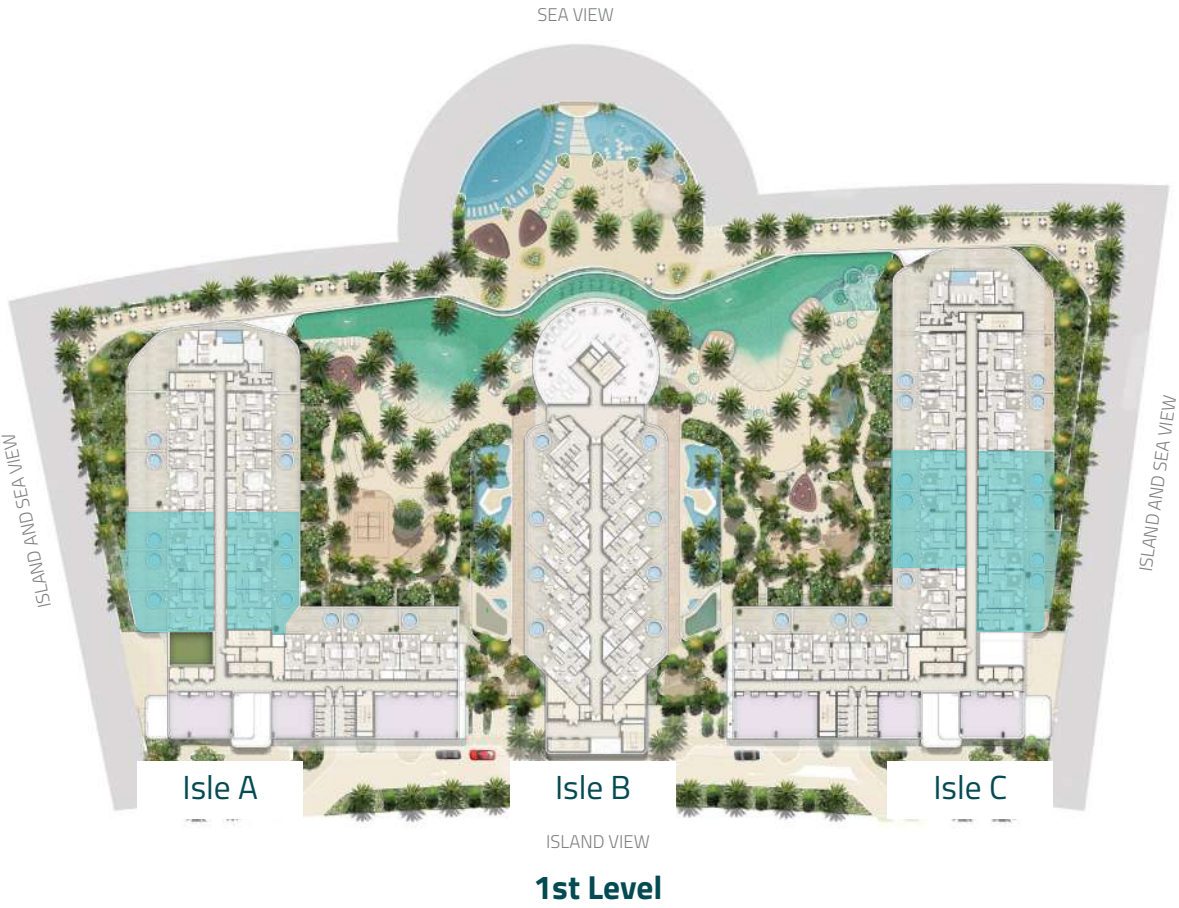
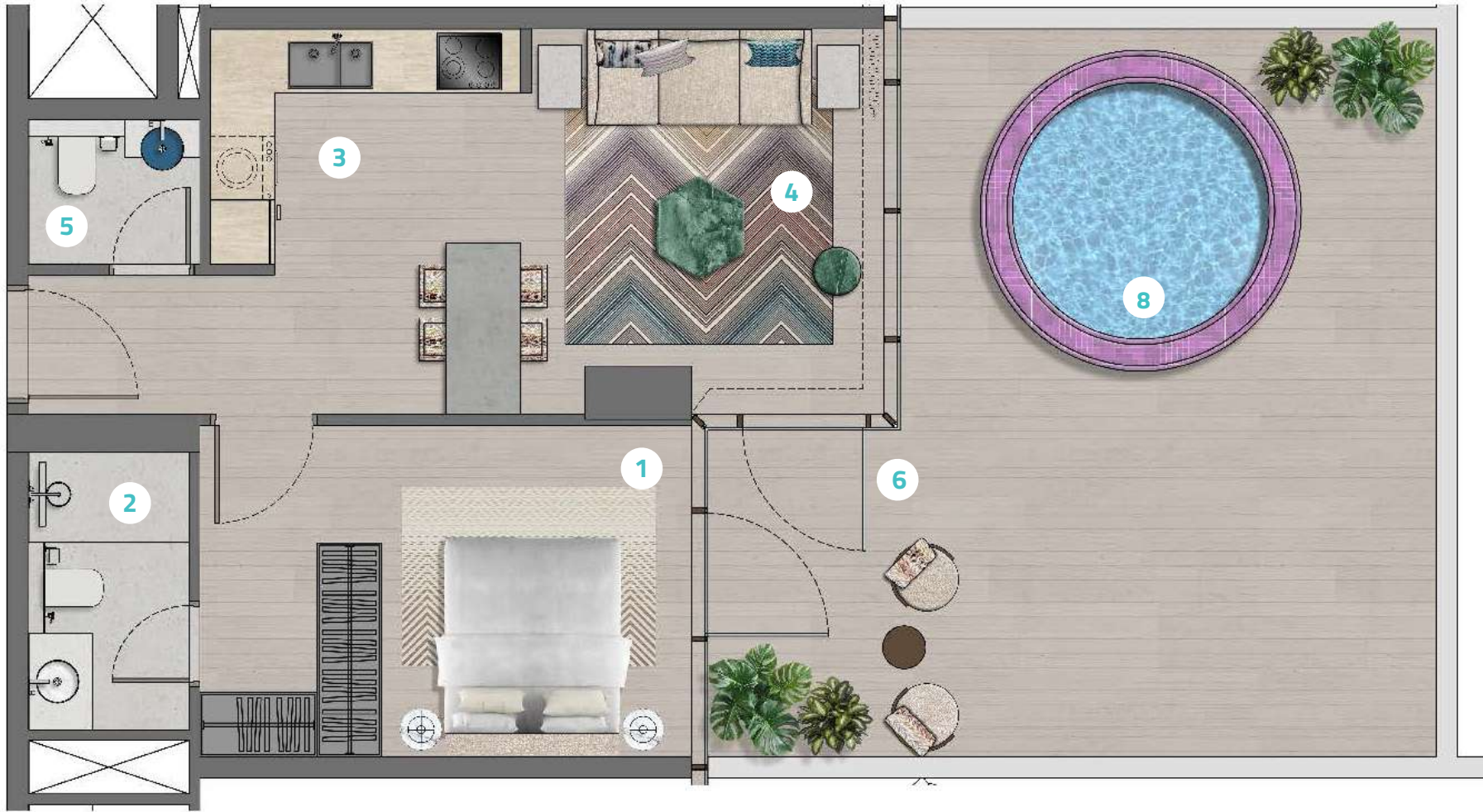

DESCRIPTION	SIZE RANGE
INTERNAL AREA	525 - 543 Sqft
BALCONY AREA	349 -646 Sqft
TOTAL AREA	874 - 1178 Sqft





# 1 Bedroom Plus | Type 2

- 1. MASTER BEDROOM (5360 X 3200)
- 2. MASTER BATHROOM (1640 X 2740)
- 3. KITCHEN/ DINING (4160 X 3860)
- 4. LIVING ROOM (3480 X 3400)
- 5. S. ROOM (2137 X 2040)
- 6. BATHROOM (2080 X 1880)
- 7. BALCONY



DESCRIPTION	SIZE RANGE
INTERNAL AREA	645 - 653 Sqft
BALCONY AREA	252 - 253 Sqft
TOTAL AREA	896 - 906 Sqft





# 1 Bedroom Plus | Type 2 With Pool

- 1. MASTER BEDROOM (5360 X 3200)
- 2. MASTER BATHROOM (1640 X 2740)
- 3. KITCHEN/ DINING (4160 X 3860)
- 4. LIVING ROOM (3480 X 3400)
- 5. S. ROOM (2137 X 2040)
- 6. BATHROOM (2080 X 1880)
- 7. BALCONY
- 8. POOL (2400 x 2400)



DESCRIPTION	SIZE RANGE
INTERNAL AREA	648 - 658 Sqft
BALCONY AREA	454 -609 Sqft
TOTAL AREA	1,104 - 1,257 Sqft





# 1 Bedroom Plus | Type 3

- 1. MASTER BEDROOM (3910 x 3000)
- 2. WALK-IN CLOSET (2240 x 1450)
- 3. MASTER BATHROOM (1539 x 3000)
- 4. KITCHEN/ DINING (2440 x 3600)
- 5. LIVING ROOM (3420 x 3700)
- 6. S. ROOM (1638 x 2980)
- 7. BATHROOM (2055 x 1940)
- 8. LAUNDRY ROOM (2055 x 1940)
- 9. BALCONY



DESCRIPTION	SIZE RANGE
INTERNAL AREA	644- 649 Sqft
BALCONY AREA	255 - 381 Sqft
TOTAL AREA	903 - 1,028 Sqft





# 1 Bedroom Plus | Type 3 with Pool

- 1. MASTER BEDROOM (3910 x 3000)
- 2. WALK-IN CLOSET (2240 x 1451)
- 3. MASTER BATHROOM (1539 x 3000)
- 4. KITCHEN/ DINING (2437 x 3600)
- 5. LIVING ROOM (3420 x 3700)
- 6. S. ROOM (1638 x 2980)
- 7. BATHROOM (2055 x 1940)
- 8. BALCONY
- 9. POOL (2400 x 2400)



DESCRIPTION	SIZE RANGE
INTERNAL AREA	648 Sqft
BALCONY AREA	465 Sqft
TOTAL AREA	1,113 Sqft





# 2 Bedroom Plus | Moodboard

## Living Area

### FINISHING MATERIALS

- 1. AUSTRALIA FABRIC SOFA
- 2. MAREA CARPET
- 3. ICELAND CUSHION
- 4. COMETEA CUSHION
- 5. BLUE RAPPORTO CHAIR
- 6. MISSONI CURTIANS
- 7. LIGHT OAK WOOD FLOORING
- 8. BLUE GLASS RIBBED UPPER CABINETS KITCHEN
- 9. LOWER CABINETS KITCHEN
- 10. CALACATTA PORCELAIN TILE COUNTERTOP
- 11. BRONZE BRUSHED FAUCET

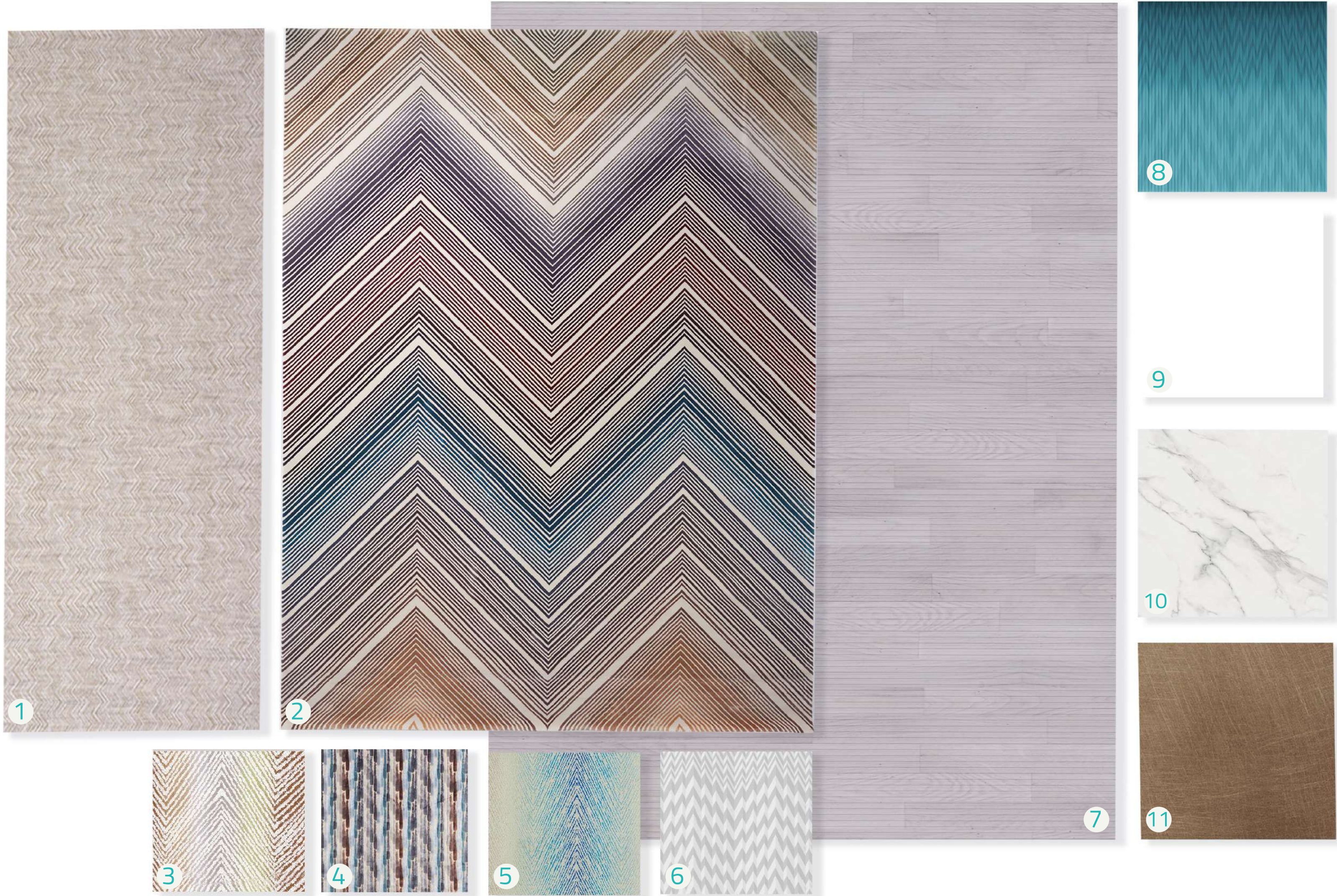



# 2 Bedroom Plus | Moodboard

## Master Bedroom

### FINISHING MATERIALS

- 1. AUSTRALIA FABRIC BED
- 2. METAL CHEVRON CARPET
- 3. WIND WHITE DUVET
- 4. GRAFFITI BLANKET
- 5. AGADIR CUSHION
- 6. ICELAND CUSHION
- 7. ANDE CUSHION
- 8. NASTRI POUF
- 9. BLUE RIBBED GLASS
- 10. LIGHT OAK WOOD FLOORING
- 11. GREY MIRROR
- 12. GLASS MOSAIC WALL
- 13. CALACATTA MARBLE SIDE TABLE





# 2 Bedroom Plus | Moodboard

## Master Bathroom

### FINISHING MATERIALS

- 1. RESIN FLOORING
- 2. FLUTED STONE WALL
- 3. BLUE GIACOMO TOWEL
- 4. LIGHT OAK WOOD VANITY
- 5. BLUE ONYX PORCELAIN COUTNER TOP VANITY
- 6. BLUE MIRROR
- 7. GOLD BRUSHED BATHROOM ACCESORIES

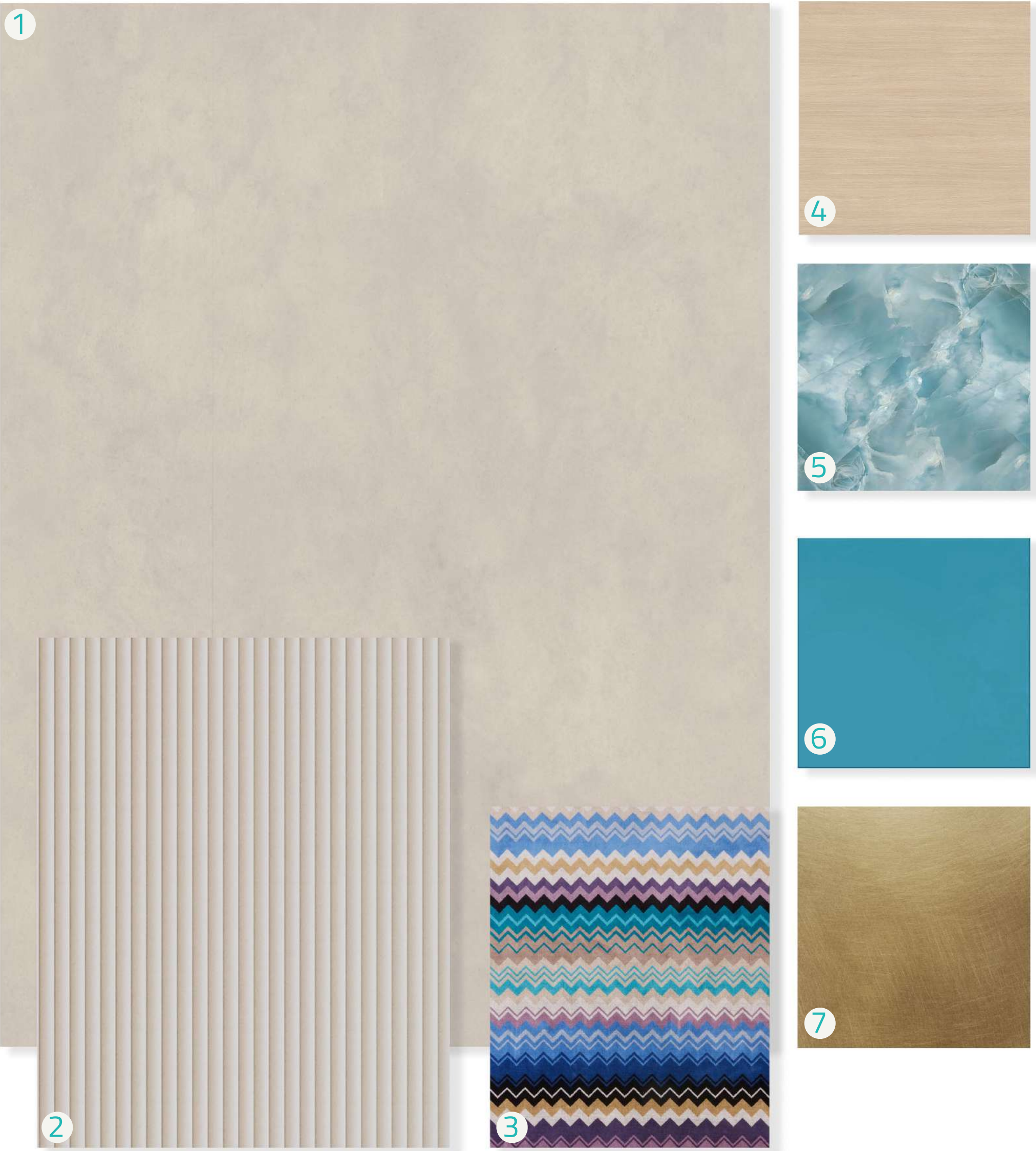



# 2 Bedroom Plus | Type 1

- 1. MASTER BEDROOM (4750 x 3000)
- 2. MASTER BATHROOM (1500 x 2550)
- 3. KITCHEN/ DINING (2900 x 3600)
- 4. LIVING ROOM (3500 x 3600)
- 5. S. ROOM (1500 x 2300)
- 6. BATHROOM (1500 x 2400)
- 7. BEDROOM (3450 x 3500)
- 8. BALCONY

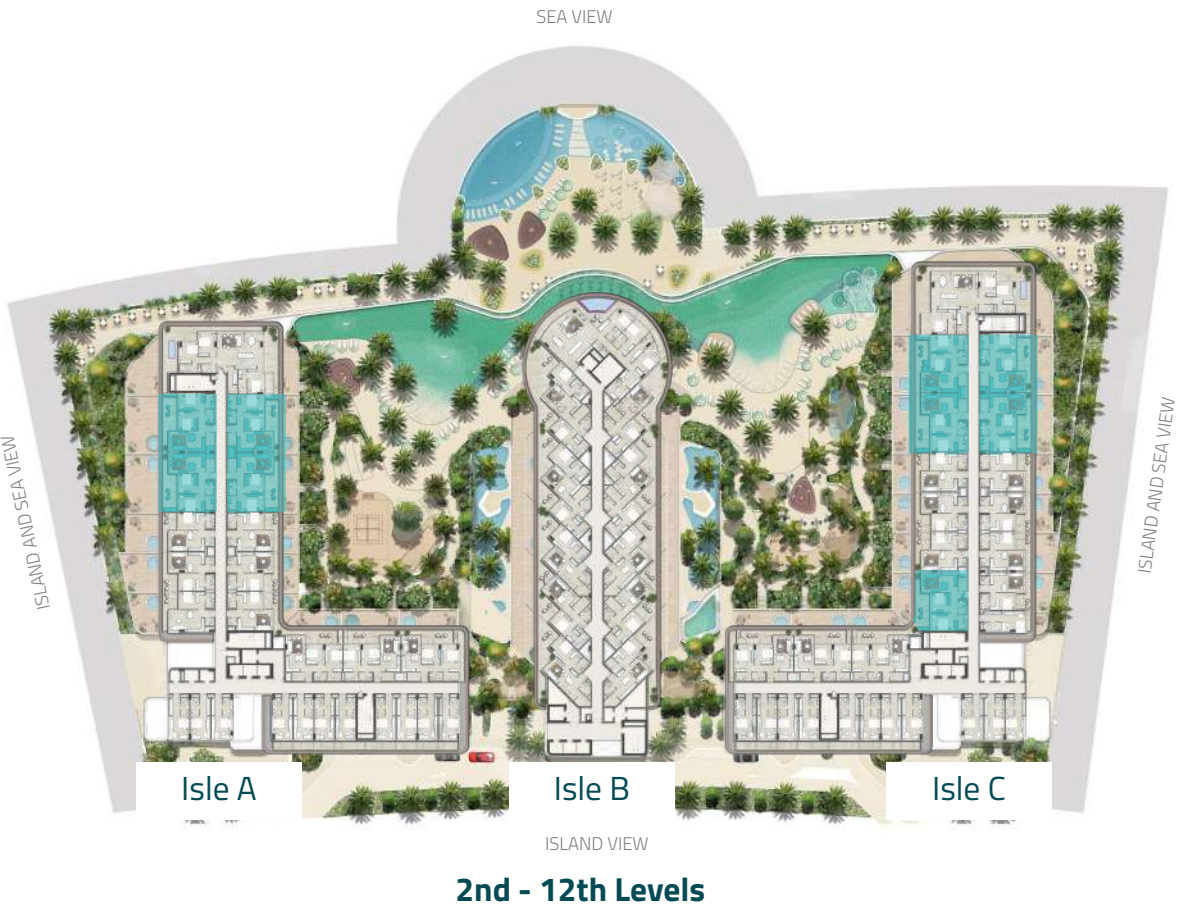

DESCRIPTION	SIZE RANGE
INTERNAL AREA	772 - 788 Sqft
BALCONY AREA	202 - 258 Sqft
TOTAL AREA	974 - 1,034 Sqft





# 2 Bedroom Plus | Type 1 with Pool

- 1. MASTER BEDROOM (4750 x 3000)
- 2. MASTER BATHROOM (1500 x 2550)
- 3. KITCHEN/ DINING (2900 x 3600)
- 4. LIVING ROOM (3500 x 3600)
- 5. S. ROOM (1500 x 2300)
- 6. BATHROOM (1500 x 2400)
- 7. BEDROOM (3450 x 3500)
- 8. BALCONY
- 9. POOL (2400 x 2400)

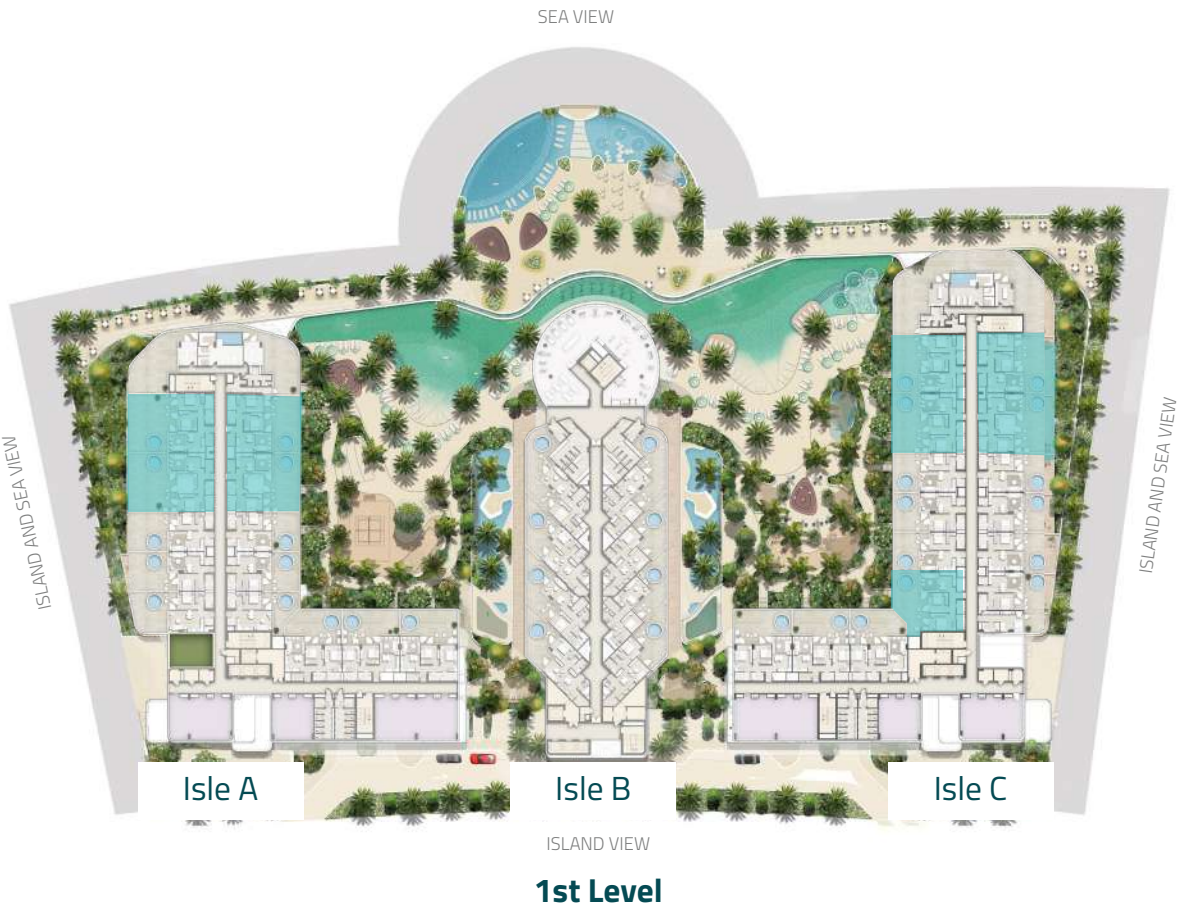

DESCRIPTION	SIZE RANGE
INTERNAL AREA	764 - 788 Sqft
BALCONY AREA	574 - 945 Sqft
TOTAL AREA	1,347- 1,733 Sqft





# 2 Bedroom Plus | Type 1-A

- 1. MASTER BEDROOM (4900 x 2950)
- 2. MASTER BATHROOM (2400 x 1500)
- 3. KITCHEN/ DINING (2850 x 3450)
- 4. LIVING ROOM (3550 x 3150)
- 5. S. ROOM (2300 x 1500)
- 6. BATHROOM (2250 x 1500)
- 7. BEDROOM (3600 x 3000)
- 8. BALCONY



2nd - 10th Level



11th Level

DESCRIPTION	SIZE RANGE
INTERNAL AREA	755 - 766 Sqft
BALCONY AREA	205 - 243 Sqft
TOTAL AREA	971- 1,004 Sqft





# 2 Bedroom Plus | Type 1-A with Pool

- 1. MASTER BEDROOM (4900 x 2950)
- 2. MASTER BATHROOM (2400 x 1500)
- 3. KITCHEN/ DINING (2850 x 3450)
- 4. LIVING ROOM (3550 x 3150)
- 5. S. ROOM (2300 x 1500)
- 6. BATHROOM (2250 x 1500)
- 7. BEDROOM (3600 x 3000)
- 8. BALCONY
- 9. POOL (2400 x 2400)

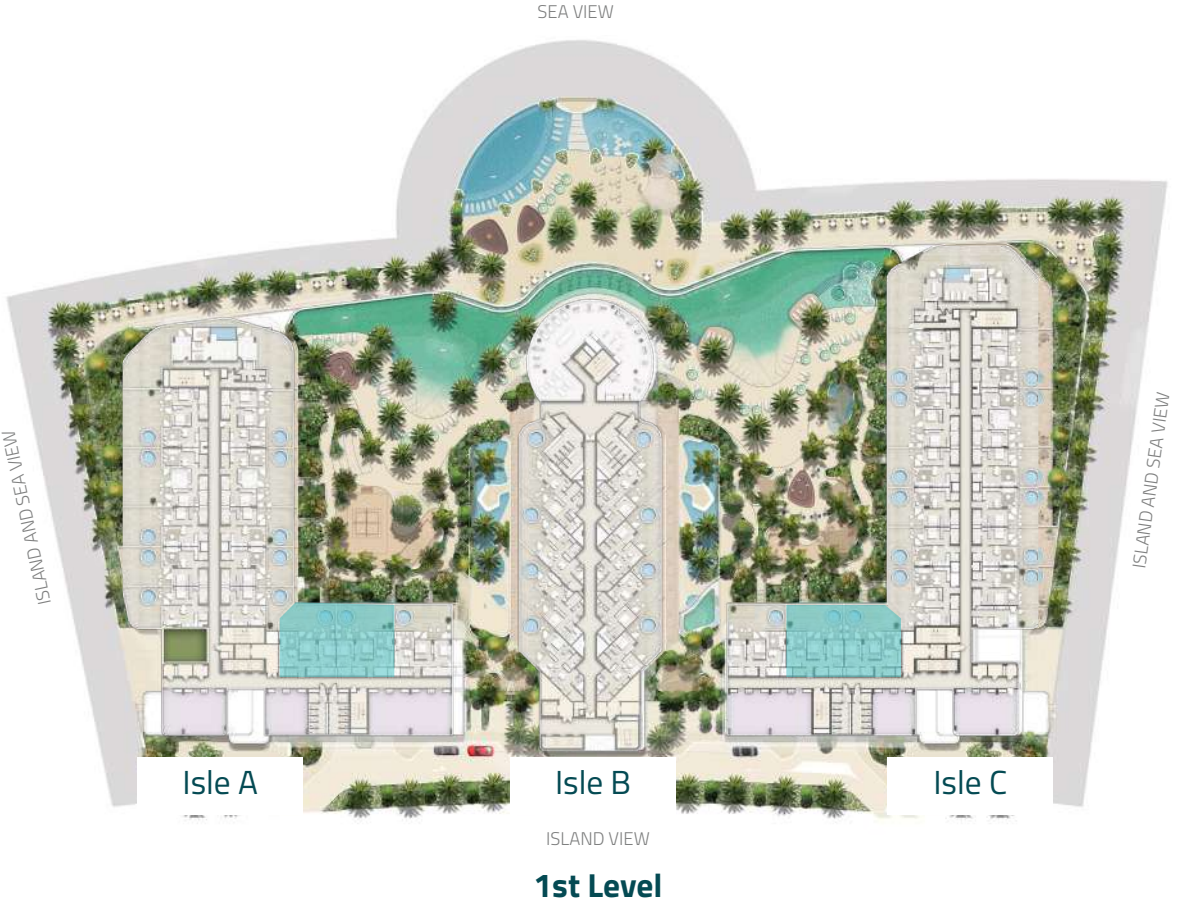

DESCRIPTION	SIZE RANGE
INTERNAL AREA	755 - 766 Sqft
BALCONY AREA	565 - 601 Sqft
TOTAL AREA	1,321- 1,366 Sqft





# 2 Bedroom Plus | Type 1-B

- 1. MASTER BEDROOM (3200 x 4000)
- 2. MASTER BATHROOM (2570 x 1500)
- 3. KITCHEN/ DINING (3450 x 2850)
- 4. LIVING ROOM (3460 x 3550)
- 5. S. ROOM (2300 x 1500)
- 6. BATHROOM (2250 x 1500)
- 7. BEDROOM (3350 x 3600)
- 8. BALCONY



DESCRIPTION	SIZE RANGE
INTERNAL AREA	780 Sqft
BALCONY AREA	307 - 308 Sqft
TOTAL AREA	1,087- 1,088 Sqft





# 2 Bedroom Plus | Type 1-B With Pool

- 1. MASTER BEDROOM (3200 x 4000)
- 2. MASTER BATHROOM (2570 x 1500)
- 3. KITCHEN/ DINING (3450 x 2850)
- 4. LIVING ROOM (3460 x 3550)
- 5. S. ROOM (2300 x 1500)
- 6. BATHROOM (2250 x 1500)
- 7. BEDROOM (3350 x 3600)
- 8. BALCONY
- 9. POOL (2400 x 2400)



DESCRIPTION	SIZE RANGE
INTERNAL AREA	775 - 776 Sqft
BALCONY AREA	603 - 604 Sqft
TOTAL AREA	1,379 Sqft





# 2 Bedroom Plus | Type 2

- 1. MASTER BEDROOM 1 (3200 x 3720)
- 2. MASTER BATHROOM 1 (2570 x 1520)
- 3. WALK-IN CLOSET 1 (1840 x 1640)
- 4. MASTER BEDROOM 2 (3000 x 3910)
- 5. MASTER BATHROOM 2 (3000 x 1540)
- 6. WALK-IN CLOSET 2 (2240 x 1450)
- 7. KITCHEN/ DINING (2760 x 2290)
- 8. LIVING ROOM (3620 x 3600)
- 9. S. ROOM (2940 x 1650)
- 10. LAUNDRY ROOM (1430 x 660)
- 11. BATHROOM (1940 x 2060)
- 12. BALCONY



DESCRIPTION	SIZE RANGE
INTERNAL AREA	905 - 914 Sqft
BALCONY AREA	392 - 594 Sqft
TOTAL AREA	1,300 - 1,499 Sqft





# 3 Bedroom + Maid | Moodboard

## Living Area

### FINISHING MATERIALS

- 1. AUSTRALIA FABRIC SOFA
- 2. MAREA CARPET
- 3. FLUIDITY CUSHION
- 4. COMETEA CUSHION
- 5. CAPRI CUSHION
- 6. GRAFITTI CUSHION
- 7. OMBRE CUSION
- 8. LIGHT OAK WOOD FLOORING
- 9. LACQUERED RIBBED KTICHEN CABINETI
- 10. GREEN GLASS RIBBED KITCHEN CABINET
- 11. TRAVERTINE PORCELAIN TILE ISLAND
- 12. GOLD BRUSHED FAUCET
- 13. ZIG ZAG RAPPORTO
- 14. RIBBED GLASS

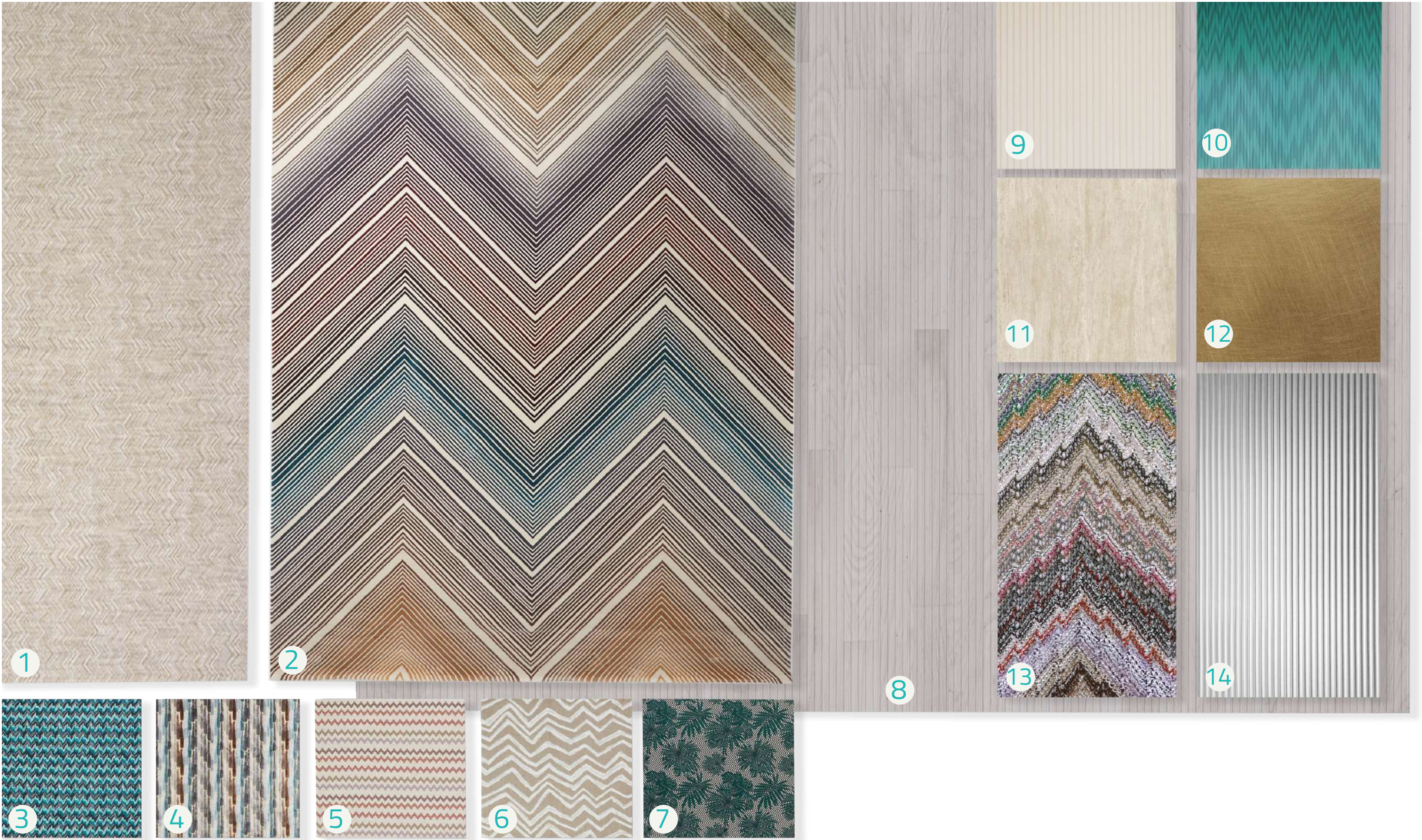



# 3 Bedroom + Maid | Moodboard

## Powder Room

### FINISHING MATERIALS

- 1. FLUTED STONE WALL
- 2. STONE EFFECT PORCELAIN TILE FLOORING & WALL
- 3. GOLD BRUSHED ACCESORIES
- 4. NATURAL OAK ENGINEERED WOOD VANITY
- 5. GREEN GLASS MIRROR
- 6. ADAM BATH TOWEL

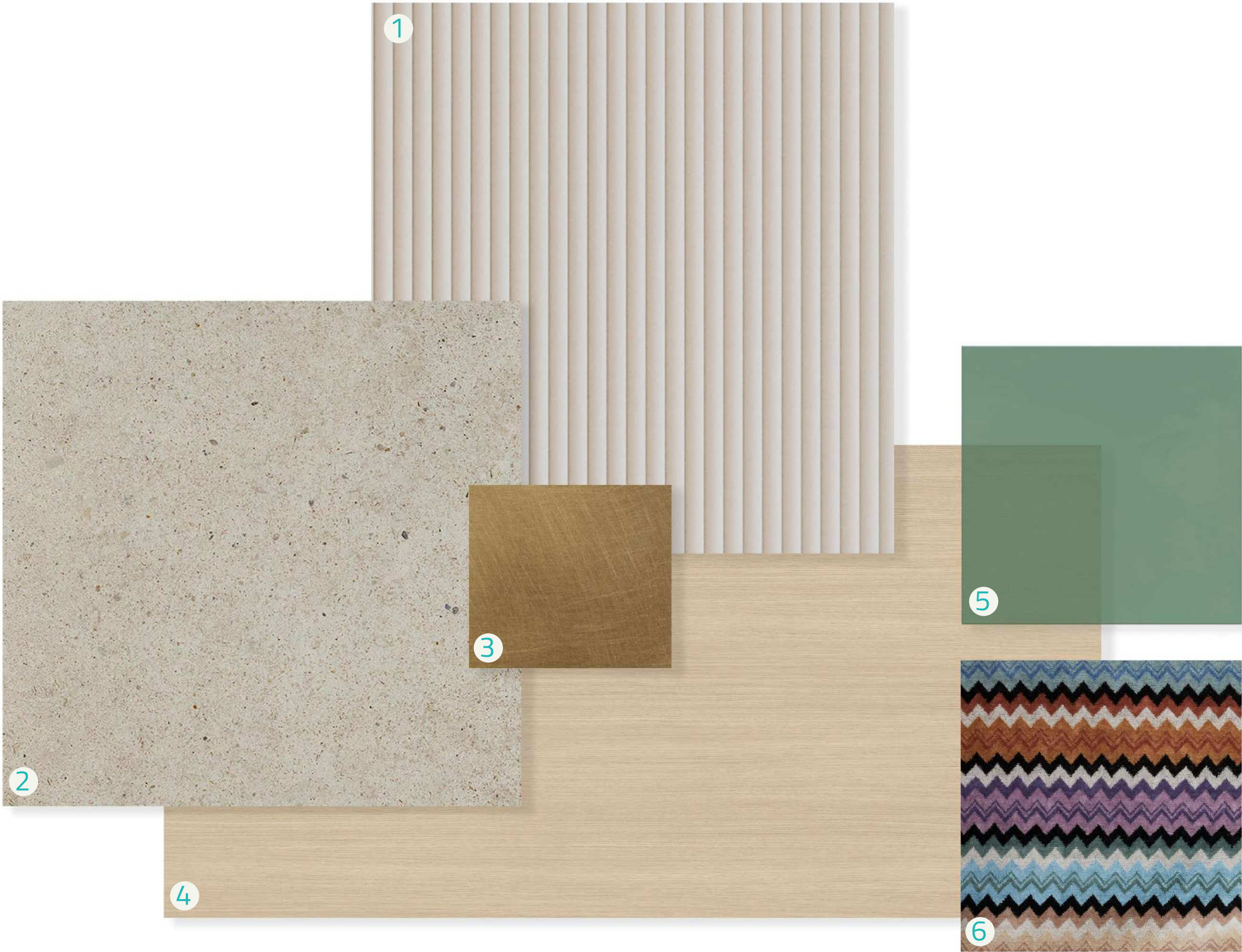



# 3 Bedroom + Maid | Moodboard

## Master Bedroom

### FINISHING MATERIALS

- 1. LIGHT OAK WOOD FLOORING
- 2. GREEN GLASS MOSAIC
- 3. CALACATTA EFFECT PORCELAIN TILE SIEDE TABLE
- 4. NASTRI FABRIC ARMCHAIR
- 5. LIGHT WOOD ARMCHAIR
- 6. METALIC CHEVRON CARPETI
- 7. GRAFFITI FABRIC
- 8. AUSTRALIA FABRIC BED
- 9. AGADIR CUSHION
- 10. TIMMY CUSION
- 11. LAYER INLAY CUSHIONI

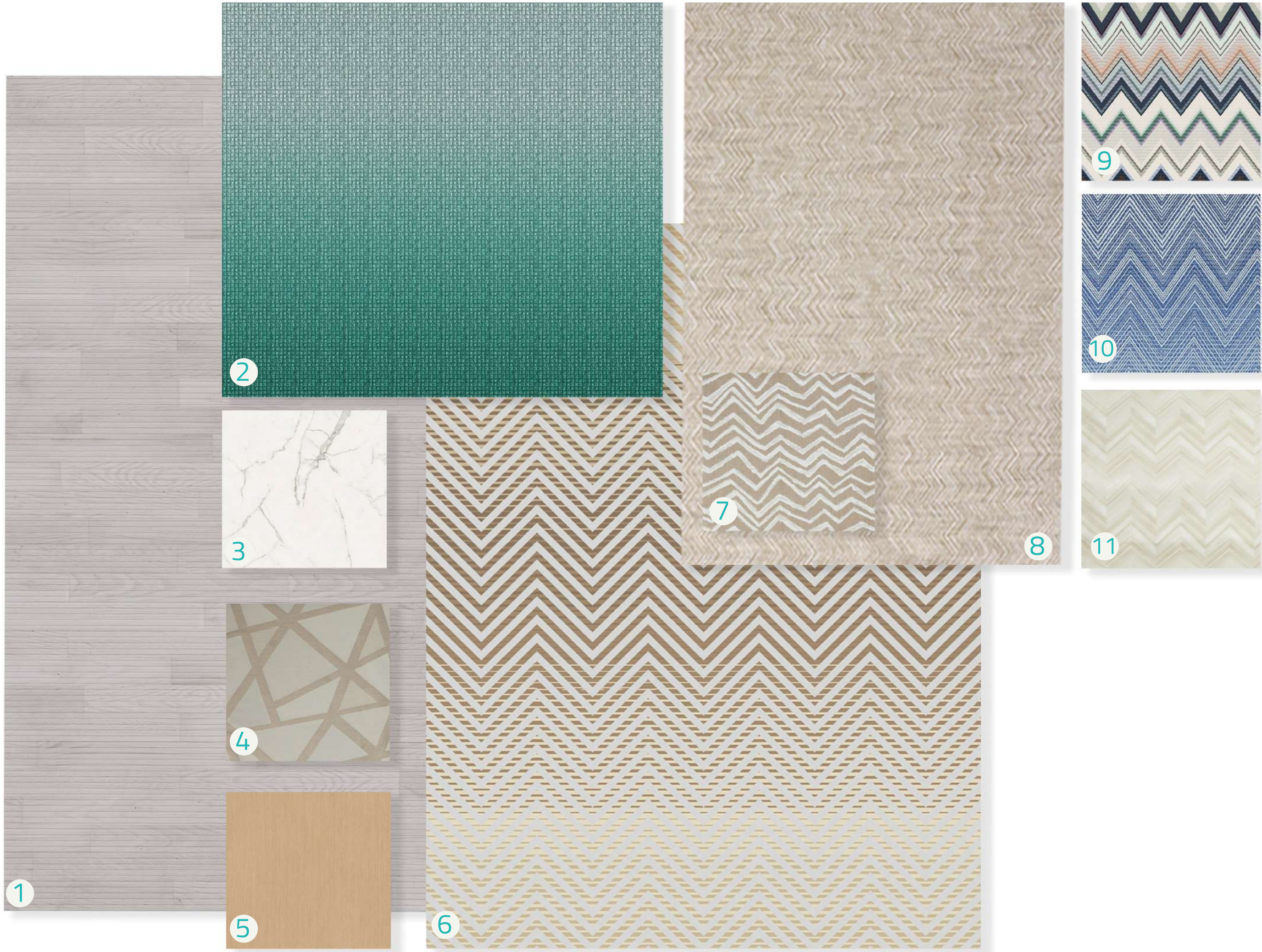



# 3 Bedroom + Maid | Moodboard

## Master Bathroom

### FINISHING MATERIALS

- 1. RESIN FLOORING
- 2. GREEN ONYX PORCELAIN TILE WALL
- 3. GOLD BRUSHED BATHROOM FIXTURES
- 4. WHITE ONXY PORCELAIN TILE COUNTER TOP
- 5. FLUTED STONE WALLI
- 6. PINK & GREEN GLASS MIRROR
- 7. MATTE LACQUERED BEIGE VANITY UNIT
- 8. GIACOMO TOWEL

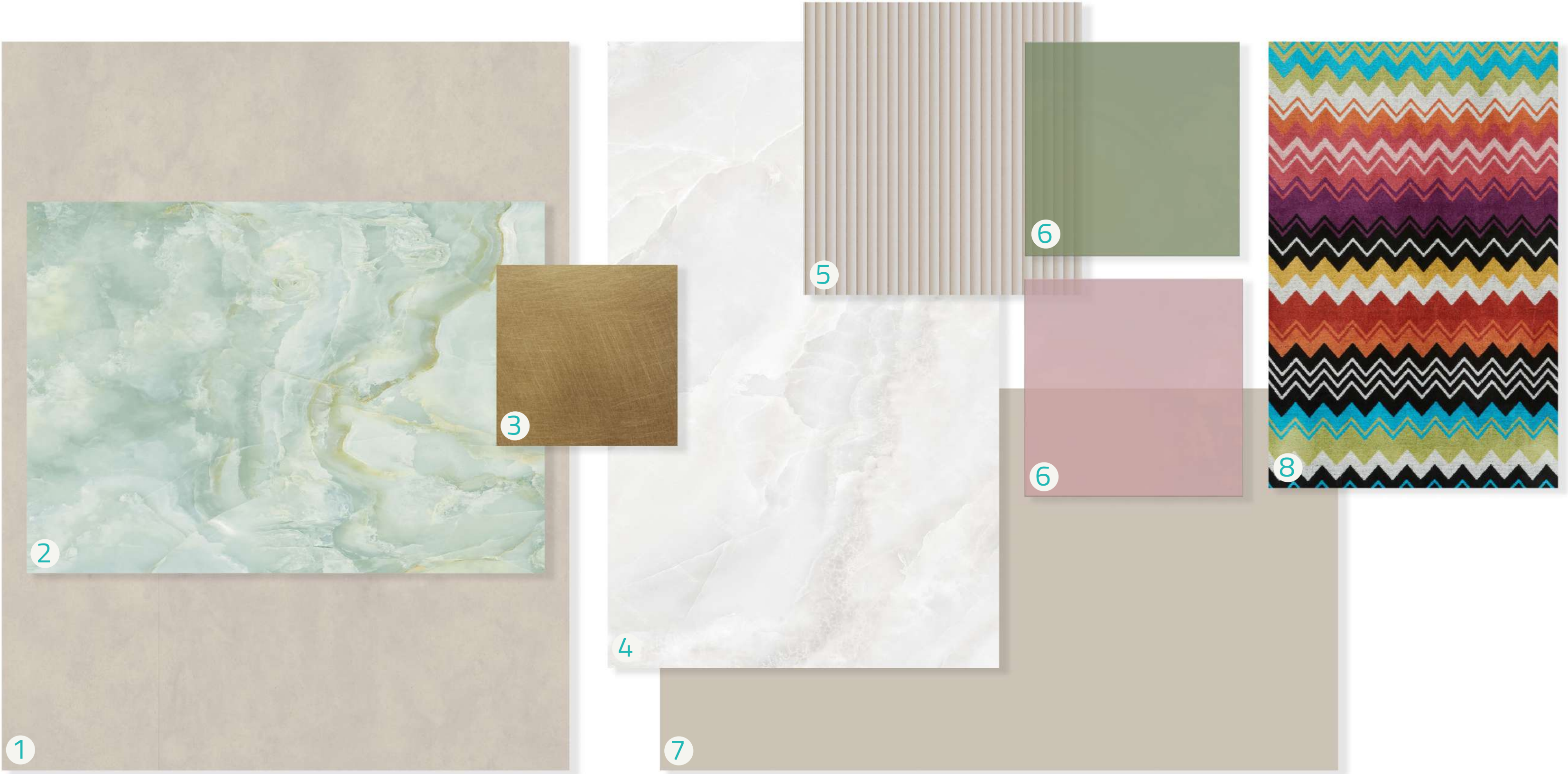



# 3 Bedroom + Maid | Moodboard

## Secondary Bedroom

### FINISHING MATERIALS

- 1. LIGHT OAK FLOORING
- 2. GREEN MATTE OLEG WALLPAPER
- 3. SESTRERE WALLPAPER
- 4. METAL CHEVROM CARPET.
- 5. GRAFITTI TEXTURE
- 6. NASTRI RELIEF CUSHIONI
- 7. ORME 3D EFFECT CUSHION
- 8. KEW CUSHION





# 3 Bedroom + Maid | Type 1

- 1. MASTER BEDROOM 1 (3540 x 3700)
- 2. MASTER BATHROOM 1 (1540 x 3600)
- 3. MASTER BEDROOM 2 (3350 x 3760)
- 4. MASTER BATHROOM 2 (3160 x 1620)
- 5. KITCHEN (3110 x 2520)
- 6. DINING (3470 x 3560)
- 7. LIVING ROOM (4650 x 3440)
- 8. MAID'S ROOM (3095 x 1560)
- 9. BATHROOM (2640 x 1640)
- 10. BEDROOM (3150 x 4220)
- 11. BALCONY
- 12. POOL (3000 x 1000)

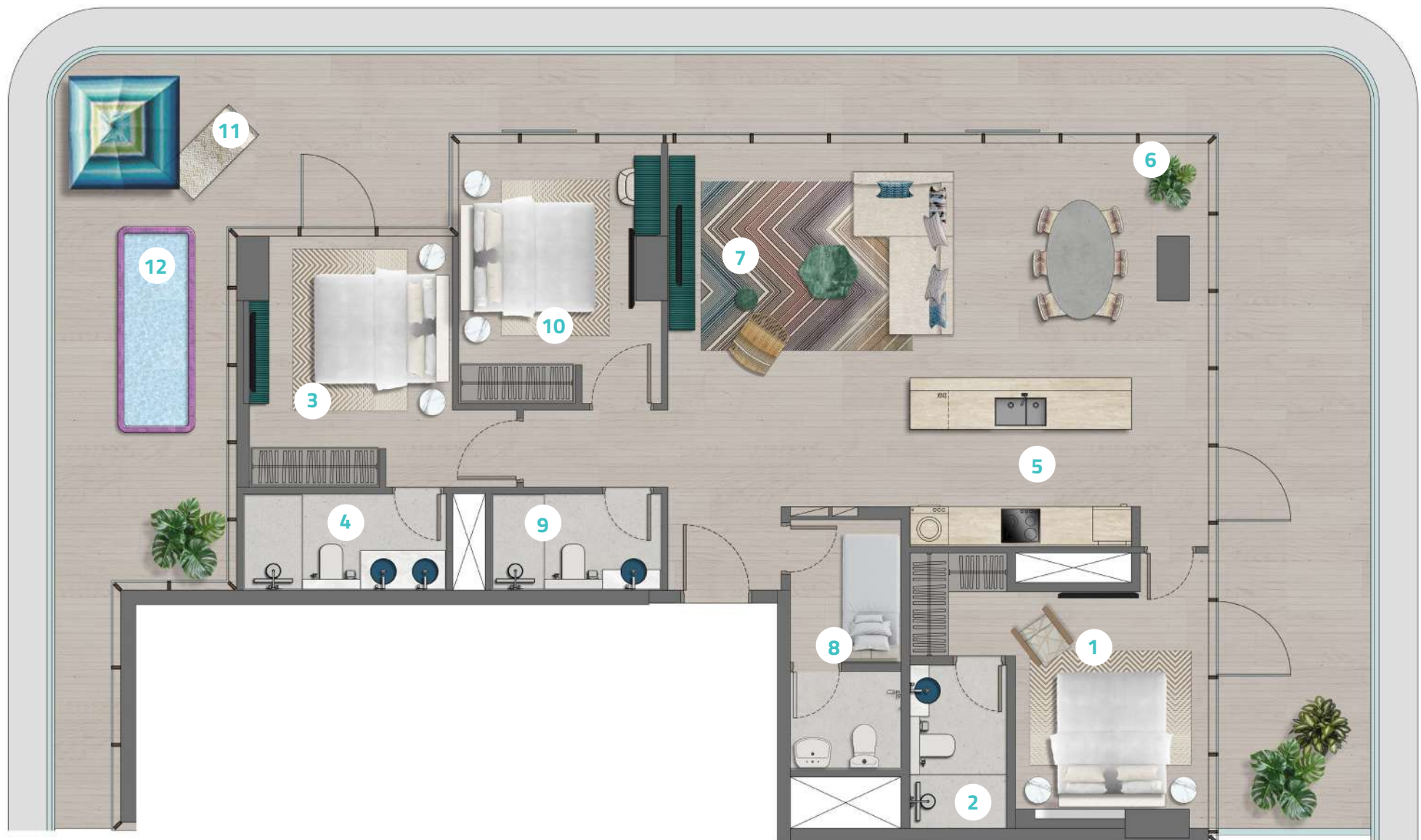

DESCRIPTION	SIZE RANGE
INTERNAL AREA	1,331 - 1,342 Sqft
BALCONY AREA	817 - 859 Sqft
TOTAL AREA	2,148 - 2,191 Sqft





# 3 Bedroom + Maid | Type 2



- 1. MASTER BEDROOM 1 (5938 x 3761)
- 2. MASTER BATHROOM 1 (1741 x 2640)
- 3. MASTER BEDROOM 2 (6095 x 3680)
- 4. MASTER BATHROOM 2 (1740 x 2642)
- 5. MASTER BEDROOM 3 (3897 x 5164)
- 6. MASTER BATHROOM 3 (3245 x 3100)
- 7. WALK-IN CLOSET (3100 x 2040)
- 8. KITCHEN (4848 x 2620)
- 9. LIVING/ DINING (6262 x 5720)
- 10. MAID'S ROOM (2600 x 1560)
- 11. MAID'S BATHROOM (2560 x 1560)
- 12. POWDER ROOM (2940 x 1300)
- 13. LAUNDRY ROOM (1690 x 1540)
- 14. BALCONY
- 15. POOL (2000 x 5730)



DESCRIPTION	SIZE RANGE
INTERNAL AREA	1,809 - 1,811 Sqft
BALCONY AREA	611 Sqft
TOTAL AREA	2,420 - 2,422 Sqft





# 3 Bedroom Plus | Type 3

- 1. MASTER BEDROOM 1 (4800 x 3370)
- 2. MASTER BATHROOM 1 (2820 x 3600)
- 3. MASTER BEDROOM 2 (4760 x 3130)
- 4. MASTER BATHROOM 2 (1640 x 2640)
- 5. KITCHEN (3830 x 3060)
- 6. LIVING ROOM (4940 x 3100)
- 7. S. ROOM (2040 x 1640)
- 8. LAUNDRY ROOM (1440 x 1641)
- 9. BATHROOM (1640 x 2350)
- 10. BEDROOM (3350 x 3320)
- 11. BALCONY
- 12. POOL (3500 x 3500)



DESCRIPTION	SIZE RANGE
INTERNAL AREA	1,109 Sqft
BALCONY AREA	2,053 Sqft
TOTAL AREA	3,162 Sqft





# 3 Bedroom Plus | Type 4

- 1. MASTER BEDROOM 1 (3840 x 3220)
- 2. MASTER BATHROOM 1 (1640 x 3220)
- 3. MASTER BEDROOM 2 (3500 x 4420)
- 4. WALK-IN CLOSET (3500 x 1740)
- 5. MASTER BATHROOM 2 (2719 x 1718)
- 6. KITCHEN (2620 x 3650)
- 7. LIVING/ DINING ROOM (5380 x 3650)
- 8. S. ROOM 1 (2180 x 1740)
- 9. S. ROOM 2 (840 x 1740)
- 10. S. ROOM 3 (8150 x 1000)
- 11. LAUNDRY ROOM (1550 x 2540)
- 12. BATHROOM (1740 x 2540)
- 13. BEDROOM (3870 x 3320)
- 14. BALCONY
- 15. POOL (3500 x 3500)



DESCRIPTION	SIZE RANGE
INTERNAL AREA	1,301 Sqft
BALCONY AREA	2,275 - 2,289 Sqft
TOTAL AREA	3,576 -3,590 Sqft







Durar is one of the leading property development groups, offering a wide range of world-class solutions. Flexibility in planning and development ensures each client receives a strategic and highly personalized solution.

Among its celebrated projects is Elie Saab Edition Jasmine Lane at Jumeirah Golf Estate, which is a statement of luxury living and the J-One project in Business Bay.







OCTA Development came from a legacy of excellence, integrity, and innovation built by OCTA Properties. A foundation of delivering high-quality and functional living spaces has evolved into a commitment to creating purpose-driven, premium developments.

OCTA Development works under the motto Life². More than just a concept, it's the philosophy of redefining modern living by enhancing every detail, amplifying quality, and transforming the ordinary into the extraordinary.

Every space designed is crafted with intent, where functionality is heightened, efficiency is escalated, and excellence is magnified. Through practical planning and uncompromising quality.

OCTA Development creates spaces where life truly flourishes.





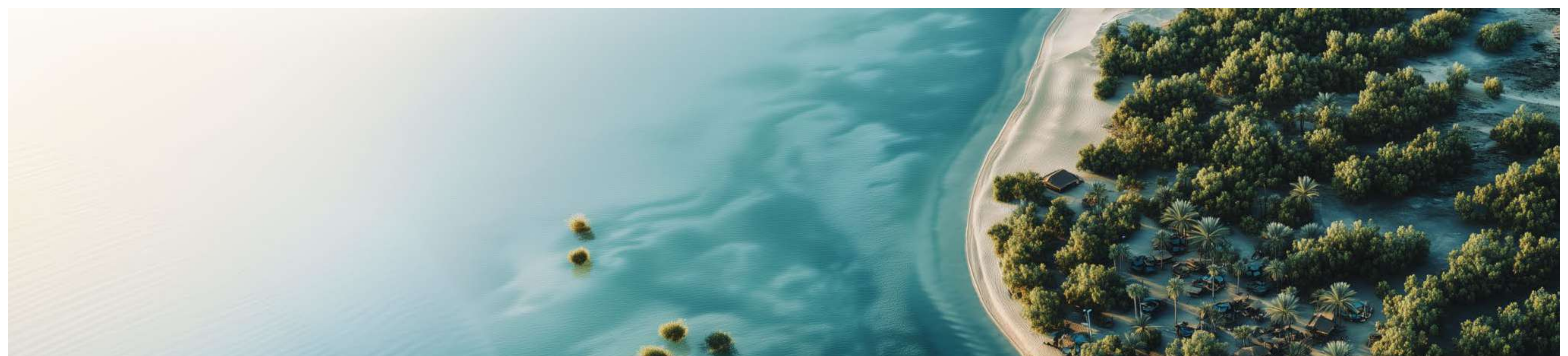

TRIO ISLE | INTERIORS BY  
**MISSONI**

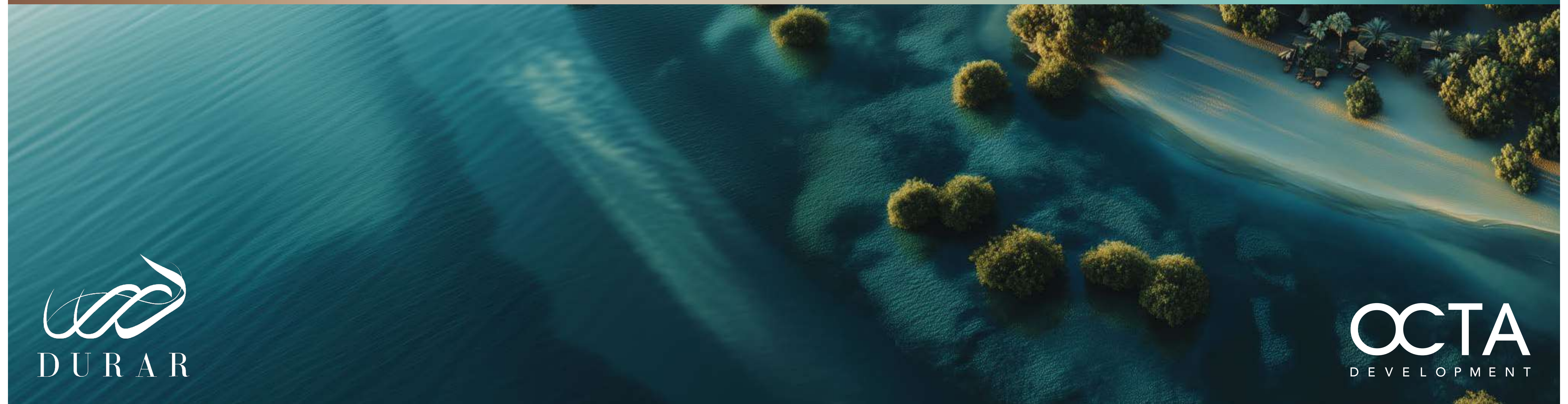

  
DURAR

  
DEVELOPMENT